

Sakura Air Conditioner User-friendly, Earth-friendly

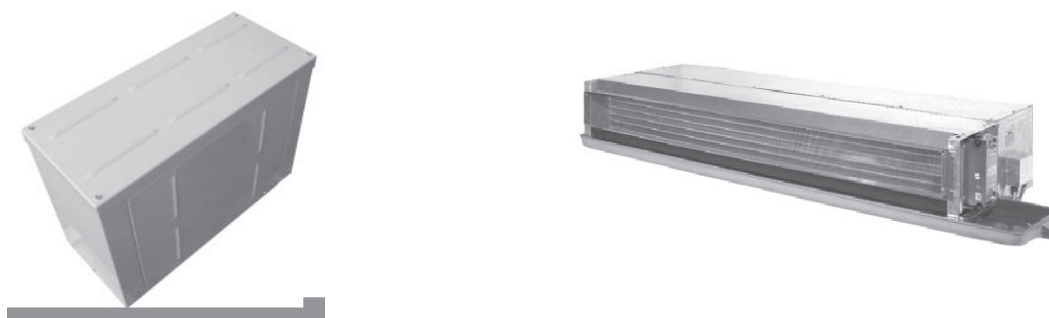

Water Source Heat Pump
Water to Air (Split Type)

Sakura Split System Units



Standard Rating Data

Water-loop conditions

Unit size	Airflow m ³ /h	Water flow m ³ /h	Cooling		Heating	
			kW	EER	kW	COP
L006	480	0.5	2.2	4.2	2.4	4.5
L009	510	0.6	2.8	3.9	3.3	4.4
L013	580	0.8	3.3	3.8	4.2	4.0
L016	700	1.1	4.1	3.9	4.8	4.0
L019	795	1.3	5.2	3.7	6.5	4.1
L024	950	1.3	5.9	3.9	7.2	4.1
L027	1250	1.7	7.1	3.7	8.8	4.0
L030	1430	2.0	8.2	3.9	9.7	4.2
J036	1750	2.3	9.2	4.0	11.7	4.5
J043	2000	2.6	11.0	3.9	12.5	4.3
J052	2100	3.1	12.6	3.8	16.0	4.2
J062	2500	3.6	14.7	4.1	20.5	4.2
J072	3200	4.2	17.7	4.0	22.0	4.3
J086	4000	5.0	21.0	4.2	23.5	4.5

Cooling capacity is based on 27°C db, 19°C wb entering air temperature, water temperature is based on 30°C entering water temperature and 35°C leaving water temperature. Heating capacity is based on 20°C entering air temperature and 20°C entering water temperature.

EER = Energy Efficiency Ratio,
COP = Coefficient of Performance

Ground-water conditions

Unit size	Airflow m ³ /h	Water flow m ³ /h	Cooling		Heating	
			kW	EER	kW	COP
L006	480	0.3	2.3	5.8	2.1	4.0
L009	510	0.3	2.9	5.4	2.8	3.9
L013	580	0.4	3.5	5.2	3.4	3.5
L016	700	0.6	4.3	5.4	4.2	3.5
L019	795	0.7	5.4	5.1	5.2	3.6
L024	950	0.7	6.2	5.4	6.1	3.6
L027	1250	0.9	7.4	5.1	7.3	3.5
L030	1430	1.0	8.6	5.4	8.5	3.7
J036	1750	1.2	9.6	5.5	9.4	4.0
J043	2000	1.3	11.5	5.4	10.9	3.8
J052	2100	1.6	13.2	5.2	13.0	3.7
J062	2500	1.8	15.4	5.6	16.1	3.7
J072	3200	2.1	18.5	5.5	18.2	3.8
J086	4000	2.5	22.0	5.8	20.0	4.0

Cooling capacity is based on 27°C db, 19°C wb entering air temperature, water temperature is based on 18°C entering water temperature and 29°C leaving water temperature. Heating capacity is based on 20°C entering air temperature and 15°C entering water temperature.

EER = Energy Efficiency Ratio,
COP = Coefficient of Performance

Ground-loop conditions

Unit size	Airflow m ³ /h	Water flow m ³ /h	Cooling		Heating	
			kW	EER	kW	COP
L006	480	0.5	2.3	5.6	1.6	3.4
L009	510	0.6	2.9	5.2	2.0	3.3
L013	580	0.8	3.5	5.1	2.7	3.0
L016	700	1.2	4.3	5.2	3.1	3.0
L019	795	1.4	5.4	4.9	4.0	3.1
L024	950	1.4	6.2	5.2	4.4	3.1
L027	1250	1.8	7.4	4.9	5.4	3.0
L030	1430	2.1	8.6	5.2	6.0	3.2
J036	1750	2.4	9.6	5.4	7.2	3.4
J043	2000	2.7	11.5	5.2	7.8	3.3
J052	2100	3.3	13.2	5.1	10.0	3.2
J062	2500	3.8	15.4	5.5	12.8	3.2
J072	3200	4.4	18.6	5.4	13.8	3.3
J086	4000	5.2	22.0	5.6	14.6	3.4

Cooling capacity is based on 27°C db, 19°C wb entering air temperature, water temperature is based on 25°C entering water temperature and 30°C leaving water temperature. Heating capacity is based on 20°C entering air temperature and 0°C entering water temperature.

EER = Energy Efficiency Ratio,
COP = Coefficient of Performance

The performance data is the same for 50Hz & 60Hz compressor are utilized. The performance data will be de-rated about 5% for R407c refrigerant.

Nomenclature

<u>J</u> Voltage	<u>-086-</u> Unit Size	<u>SPE</u> Unit Type
L = 220~240/50/1	006 = 2.2kW cooling	SPE = Condensing Unit
D = 208~230/60/1	009 = 2.8kW cooling	SPI = Indoor Fan Coil Unit
J = 380~415/50/3	013 = 3.3kW cooling	
H = 380/60/3	016 = 4.1kW cooling	
G = 460/60/3	019 = 5.2kW cooling	
	024 = 5.9kW cooling	
	027 = 7.1kW cooling	
	030 = 8.2kW cooling	
	036 = 9.2kW cooling	
	043 = 11.0kW cooling	
	052 = 12.6kW cooling	
	062 = 14.7kW cooling	
	072 = 17.7kW cooling	
	086 = 21.0kW cooling	

Unit Description

Sakura offers a complete line of Split System Unit from 1/2 ton to 6 ton capacity. Each system consists of a condensing unit which can be installed inside or outside the building and an indoor fan coil unit.

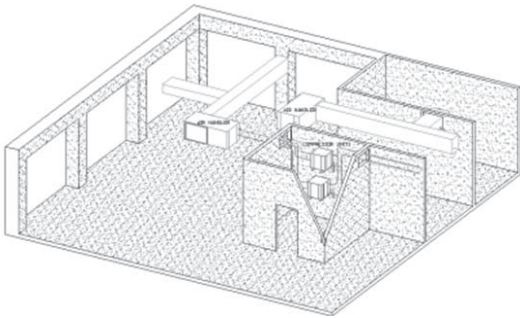

Condensing Unit

The condensing unit provides the refrigerant to the indoor unit and includes a compressor and water-to-refrigerant insulated (only Geothermal type) coaxial heat exchanger. The cabinet is constructed of lead-free galvanized steel and is powder painted.

The cabinet is fully insulated with 15mm thick, 48kg/m³ density, skin coated fiberglass. The entire bottom panel is similarly insulated to prevent condensation and to reduce noise transmission. Two large access panels allow service to all major components.

The compressor is rotary or scroll type. Also included is an expansion valve or capillary tube, access valves, lockout relay, and high/low pressure safety switches.

All units incorporate female NPT copper or steel water connection mounted outside the cabinet for connection of flexible hoses.

Indoor Unit

The indoor unit includes the air coil, fan assembly, filter and control box.

Ultra-Slim Profile

The compact light weight design of the indoor unit makes it ideal for above ceiling installations where space is limited.

High Efficiency Coil

The special coil design promotes the mixing of warm and cold air, resulting in high thermal efficiency and lower operating costs.

Quiet Centrifugal Fan Assembly

High efficiency fan assembly minimizes vibration and noise.

Indoor Air Quality Drain Pan

The extended positive slope drain pan is removable and is coated with an epoxy finish for easy cleaning to help prevent microbial growth and corrosion. The drain pan is insulated with a form-fitted closed cell insulation to prevent condensation build-up on the outside of the drain pan.

Insulation Out Of Airstream

Aluminum foil face insulation on top panel prevents insulation fibres from entering the airstream for improved indoor air quality.

Standard Return Air Plenum

Unit comes with standard with fully-insulated return air plenum.

Field Flexible Piping Connectins

Units are easily converted to opposite-hand connection without requiring additional parts or a conversion kit. Units may be ordered with left or right hand piping connections.

Capacity Data

Split System Unit Size 006

50 Hertz, SI Units

Ent. Water. °C	Water-Flow M ³ /h	Pressure Drop kpa	COOLING						HEATING					
			Ent. Air Db/wb°C	Total Watts	Sensible Watts	Ht. Rej Watts	Unit kW	Lvg. Water. °C	Ent. Water. °C	Ent. Air °C	Total Watts	Ht. Abs Watts	Unit kW	
4.4	0.22	4.10	23.9/17.2	2.390	1.721	2.790	0.400	15.3	-4	10.0	1.464	1.091	0.373	
			26.7/19.4	2.527	1.971	2.933	0.406	15.9		15.6	1.409	1.007	0.402	
			28.3/20.6	2.606	2.163	3.014	0.409	16.2		21.1	1.358	0.930	0.428	
			30.0/21.7	2.689	2.420	3.101	0.412	16.5		26.7	1.205	0.752	0.453	
	0.36	7.60	23.9/17.2	2.602	1.873	2.984	0.382	11.5		10.0	1.597	1.218	0.379	
			26.7/19.4	2.754	2.148	3.142	0.388	11.9		15.6	1.518	1.108	0.410	
			28.3/20.6	2.840	2.357	3.232	0.392	12.1		21.1	1.449	1.013	0.436	
			30.0/21.7	2.932	2.639	3.328	0.396	12.3		26.7	1.322	0.860	0.462	
	0.50	11.70	23.9/17.2	2.626	1.891	2.999	0.372	9.6		10.0	1.745	1.359	0.386	
			26.7/19.4	2.788	2.175	3.166	0.378	9.8		15.6	1.637	1.220	0.417	
			28.3/20.6	2.880	2.391	3.261	0.381	10.0		21.1	1.548	1.104	0.444	
			30.0/21.7	2.978	2.680	3.362	0.384	10.2		26.7	1.455	0.984	0.471	
10.0	0.22	4.10	23.9/17.2	2.273	1.659	2.705	0.433	20.6	4.4	10.0	1.818	1.428	0.390	
			26.7/19.4	2.410	1.904	2.849	0.439	21.1		15.6	1.705	1.284	0.421	
			28.3/20.6	2.488	2.090	2.931	0.443	21.5		21.1	1.610	1.162	0.448	
			30.0/21.7	2.571	2.340	3.018	0.446	21.8		26.7	1.513	1.038	0.475	
	0.36	7.60	23.9/17.2	2.469	1.802	2.886	0.417	16.9		10.0	1.901	1.501	0.399	
			26.7/19.4	2.615	2.066	3.038	0.423	17.3		15.6	1.783	1.351	0.432	
			28.3/20.6	2.699	2.268	3.125	0.426	17.5		21.1	1.682	1.223	0.460	
			30.0/21.7	2.789	2.538	3.218	0.429	17.7		26.7	1.581	1.094	0.487	
	0.50	11.70	23.9/17.2	2.625	1.916	3.026	0.400	15.2		10.0	1.926	1.518	0.408	
			26.7/19.4	2.777	2.194	3.183	0.406	15.5		15.6	1.807	1.367	0.441	
			28.3/20.6	2.864	2.406	3.273	0.409	15.6		21.1	1.704	1.236	0.468	
			30.0/21.7	2.956	2.690	3.368	0.412	15.8		26.7	1.602	1.105	0.497	
21.1	0.22	4.10	23.9/17.2	2.068	1.551	2.601	0.533	31.3	10.0	10.0	2.117	1.700	0.416	
			26.7/19.4	2.188	1.772	2.728	0.541	31.8		15.6	1.985	1.535	0.450	
			28.3/20.6	2.256	1.940	2.801	0.545	32.0		21.1	1.872	1.394	0.479	
			30.0/21.7	2.328	2.119	2.878	0.550	32.3		26.7	1.761	1.253	0.507	
	0.36	7.60	23.9/17.2	2.277	1.708	2.789	0.512	27.8		10.0	2.212	1.785	0.427	
			26.7/19.4	2.396	1.941	2.916	0.519	28.1		15.6	2.075	1.614	0.462	
			28.3/20.6	2.465	2.120	2.988	0.523	28.2		21.1	1.958	1.467	0.491	
			30.0/21.7	2.537	2.309	3.065	0.527	28.4		26.7	1.841	1.321	0.520	
	0.50	11.70	23.9/17.2	2.364	1.773	2.863	0.499	26.0		10.0	2.241	1.806	0.435	
			26.7/19.4	2.503	2.027	3.008	0.506	26.3		15.6	2.102	1.632	0.470	
			28.3/20.6	2.582	2.221	3.092	0.510	26.4		21.1	1.984	1.484	0.500	
			30.0/21.7	2.666	2.426	3.180	0.514	26.6		26.7	1.865	1.334	0.531	
29.4	0.22	4.10	23.9/17.2	1.909	1.470	2.489	0.580	39.1	21.1	10.0	2.741	2.275	0.466	
			26.7/19.4	2.018	1.683	2.606	0.589	39.6		15.6	2.571	2.068	0.503	
			28.3/20.6	2.080	1.838	2.674	0.594	39.8		21.1	2.426	1.891	0.535	
			30.0/21.7	2.146	2.060	2.745	0.599	40.1		26.7	2.281	1.713	0.568	
	0.36	7.60	23.9/17.2	2.075	1.598	2.628	0.553	35.7		10.0	2.866	2.388	0.478	
			26.7/19.4	2.195	1.830	2.756	0.561	36.0		15.6	2.689	2.173	0.516	
			28.3/20.6	2.263	2.000	2.829	0.566	36.2		21.1	2.536	1.987	0.549	
			30.0/21.7	2.335	2.242	2.906	0.571	36.3		26.7	2.249	1.687	0.562	
	0.50	11.70	23.9/17.2	2.171	1.672	2.710	0.539	34.1		10.0	2.739	2.269	0.470	
			26.7/19.4	2.310	1.927	2.857	0.547	34.3		15.6	2.569	2.061	0.508	
			28.3/20.6	2.390	2.112	2.941	0.551	34.5		21.1	2.424	1.883	0.541	
			30.0/21.7	2.474	2.375	3.030	0.556	34.6		26.7	2.278	1.705	0.573	
32.2	0.22	4.10	23.9/17.2	1.830	1.418	2.432	0.602	41.7	29.4	10.0	2.884	2.401	0.482	
			26.7/19.4	1.943	1.636	2.554	0.611	42.2		15.6	2.705	2.184	0.521	
			28.3/20.6	2.007	1.792	2.623	0.616	42.5		21.1	2.552	1.998	0.554	
			30.0/21.7	2.075	2.013	2.697	0.622	42.7		26.7	2.399	1.812	0.587	
	0.36	7.60	23.9/17.2	2.006	1.555	2.586	0.580	38.4		10.0	3.015	2.521	0.494	
			26.7/19.4	2.119	1.784	2.707	0.589	38.7		15.6	2.828	2.295	0.534	
			28.3/20.6	2.183	1.949	2.777	0.594	38.8		21.1	2.669	2.100	0.568	
			30.0/21.7	2.251	2.184	2.851	0.599	39.0		26.7	2.508	1.906	0.602	
	0.50	11.70	23.9/17.2	2.130	1.651	2.694	0.563	36.8		10.0	3.055	2.551	0.504	
			26.7/19.4	2.243	1.889	2.815	0.572	37.0		15.6	2.865	2.321	0.544	
			28.3/20.6	2.307	2.061	2.884	0.577	37.2		21.1	2.703	2.125	0.579	
			30.0/21.7	2.376	2.305	2.958	0.582	37.3		26.7	2.542	1.928	0.613	
37.8	0.22	4.10	23.9/17.2	1.701	1.344	2.352	0.651	47.0	32.2	10.0	2.968	2.475	0.493	
			26.7/19.4	1.813	1.560	2.474	0.661	47.5		15.6	2.783	2.252	0.531	
			28.3/20.6	1.878	1.709	2.544	0.667	47.7		21.1	2.626	2.060	0.565	
			30.0/21.7	1.946	1.927	2.619	0.673	48.0		26.7	2.469	1.870	0.599	
	0.36	7.60	23.9/17.2	1.865	1.473	2.488	0.623	43.7		All data is with 100% water (no antifreeze) and no pumping penalty. Unit kW data includes fan motor. Total Capacity Correction Factory (% by Weight)				
			26.7/19.4	1.978	1.701	2.611	0.633	44.0						
			28.3/20.6	2.042	1.858	2.681	0.639	44.2						
			30.0/21.7	2.111	2.089	2.755	0.645	44.4						
	0.50	11.70	23.9/17.2	1.980	1.564	2.582	0.602	42.2						
			26.7/19.4	2.097	1.803	2.708	0.611	42.5						
			28.3/20.6	2.164	1.969	2.780	0.616	42.6						
			30.0/21.7	2.236	2.213	2.857	0.622	42.7						
43.3	0.50	11.70	23.9/17.2	1.719	1.392	2.372	0.653	47.4						
			26.7/19.4	1.925	1.694	2.586	0.662	47.7						
			28.3/20.6	2.042	1.899	2.709	0.667	48.0						
			30.0/21.7	2.167	2.145	2.839	0.672	48.2						

Split WSHP

All data is with 100% water (no antifreeze) and no pumping penalty. Unit kW data includes fan motor.

Total Capacity Correction Factory (% by Weight)

METHANOL	10%	15%	20%
Cooling	1.00	0.99	0.99
Heating	0.99	0.98	0.97

ETHANOL	10%	15%	20%
Cooling	1.00	1.00	1.00
Heating	0.99	0.98	0.97

PROPYLENE GLYCOL	15%	20%	25%
Cooling	0.98	0.97	0.96
Heating	0.96	0.95	0.93

Capacity Data

Split System Unit Size 009

Low Temperature Operation – Anti-freeze Require

Ent. Water. °C	Water-Flow M ³ /h	Pressure Drop kpa	COOLING						HEATING					
			Ent. Air Db/wb°C	Total Watts	Sensible Watts	Ht. Rej Watts	Unit kW	Lvg. Water. °C	Ent. Water. °C	Ent. Air °C	Total Watts	Ht. Abs Watts	Unit kW	
4.4	0.32	5.50	23.9/17.2	3.077	2.216	3.626	0.548	14.1	-4	10.0	2.078	1.550	0.527	
			26.7/19.4	3.214	2.507	3.767	0.554	14.5		15.6	1.979	1.410	0.569	
			28.3/20.6	3.291	2.732	3.848	0.557	14.7		21.1	1.893	1.288	0.605	
			30.0/21.7	3.374	3.037	3.934	0.560	15.0		26.7	1.808	1.167	0.641	
	0.44	10.30	23.9/17.2	3.351	2.413	3.875	0.524	12.0		10.0	2.106	1.569	0.537	
			26.7/19.4	3.502	2.731	4.032	0.530	12.3		15.6	2.006	1.426	0.580	
			28.3/20.6	3.588	2.978	4.122	0.534	12.5		21.1	1.919	1.303	0.617	
			30.0/21.7	3.679	3.311	4.217	0.538	12.6		26.7	1.834	1.180	0.653	
	0.60	15.90	23.9/17.2	3.386	2.438	3.896	0.510	10.0		10.0	2.135	1.589	0.546	
			26.7/19.4	3.547	2.766	4.062	0.515	10.2		15.6	2.033	1.443	0.590	
			28.3/20.6	3.638	3.020	4.157	0.518	10.4		21.1	1.946	1.318	0.628	
			30.0/21.7	3.736	3.362	4.257	0.522	10.5		26.7	1.859	1.193	0.667	
10.0	0.32	5.50	23.9/17.2	2.929	2.138	3.522	0.592	19.5	4.4	10.0	2.334	1.780	0.554	
			26.7/19.4	3.065	2.422	3.664	0.599	19.8		15.6	2.189	1.590	0.600	
			28.3/20.6	3.143	2.640	3.745	0.602	20.1		21.1	2.067	1.429	0.637	
			30.0/21.7	3.226	2.935	3.832	0.606	20.3		26.7	1.943	1.266	0.676	
	0.44	10.30	23.9/17.2	3.181	2.322	3.752	0.571	17.3		10.0	2.440	1.872	0.568	
			26.7/19.4	3.327	2.628	3.903	0.576	17.6		15.6	2.290	1.675	0.615	
			28.3/20.6	3.410	2.864	3.989	0.579	17.8		21.1	2.160	1.506	0.654	
			30.0/21.7	3.499	3.184	4.081	0.583	18.0		26.7	2.030	1.337	0.693	
	0.60	15.90	23.9/17.2	3.381	2.468	3.929	0.548	15.6		10.0	2.472	1.892	0.580	
			26.7/19.4	3.531	2.790	4.085	0.554	15.9		15.6	2.320	1.693	0.627	
			28.3/20.6	3.618	3.039	4.174	0.557	16.0		21.1	2.188	1.522	0.666	
			30.0/21.7	3.709	3.375	4.269	0.560	16.1		26.7	2.057	1.350	0.707	
21.1	0.32	5.50	23.9/17.2	2.663	1.997	3.393	0.730	30.2	10.0	10.0	2.743	2.188	0.555	
			26.7/19.4	2.782	2.253	3.519	0.737	30.6		15.6	2.573	1.973	0.600	
			28.3/20.6	2.850	2.451	3.591	0.742	30.8		21.1	2.427	1.788	0.638	
			30.0/21.7	2.922	2.659	3.668	0.747	31.0		26.7	2.282	1.605	0.677	
	0.44	10.30	23.9/17.2	2.927	2.195	3.629	0.701	28.2		10.0	2.867	2.298	0.569	
			26.7/19.4	3.046	2.467	3.754	0.708	28.4		15.6	2.690	2.074	0.616	
			28.3/20.6	3.113	2.678	3.826	0.712	28.6		21.1	2.538	1.882	0.655	
			30.0/21.7	3.185	2.899	3.902	0.716	28.7		26.7	2.386	1.692	0.694	
	0.60	15.90	23.9/17.2	3.045	2.284	3.728	0.683	26.4		10.0	2.905	2.324	0.581	
			26.7/19.4	3.183	2.578	3.873	0.690	26.7		15.6	2.725	2.098	0.627	
			28.3/20.6	3.262	2.805	3.956	0.694	26.8		21.1	2.572	1.905	0.667	
			30.0/21.7	3.345	3.044	4.043	0.698	26.9		26.7	2.417	1.709	0.708	
29.4	0.32	5.50	23.9/17.2	2.458	1.892	3.252	0.794	38.1	21.1	10.0	3.552	2.931	0.621	
			26.7/19.4	2.566	2.140	3.369	0.803	38.5		15.6	3.333	2.662	0.671	
			28.3/20.6	2.627	2.322	3.435	0.808	38.6		21.1	3.144	2.431	0.713	
			30.0/21.7	2.693	2.585	3.506	0.814	38.8		26.7	2.956	2.199	0.757	
	0.44	10.30	23.9/17.2	2.672	2.057	3.430	0.758	36.1		10.0	3.714	3.077	0.637	
			26.7/19.4	2.791	2.327	3.556	0.766	36.3		15.6	3.485	2.797	0.688	
			28.3/20.6	2.858	2.527	3.629	0.770	36.5		21.1	3.286	2.555	0.732	
			30.0/21.7	2.930	2.813	3.705	0.775	36.6		26.7	3.089	2.314	0.775	
	0.60	15.90	23.9/17.2	2.802	2.157	3.540	0.738	34.5		10.0	3.763	3.115	0.648	
			26.7/19.4	2.940	2.452	3.686	0.746	34.7		15.6	3.530	2.829	0.701	
			28.3/20.6	3.019	2.668	3.769	0.750	34.8		21.1	3.330	2.584	0.746	
			30.0/21.7	3.102	2.978	3.857	0.755	34.9		26.7	3.130	2.339	0.791	
32.2	0.32	5.50	23.9/17.2	2.360	1.829	3.185	0.825	40.8	29.4	10.0	3.924	3.214	0.710	
			26.7/19.4	2.471	2.081	3.305	0.834	41.1		15.6	3.682	2.915	0.767	
			28.3/20.6	2.535	2.264	3.374	0.839	41.3		21.1	3.473	2.658	0.815	
			30.0/21.7	2.603	2.525	3.447	0.844	41.5		26.7	3.265	2.402	0.863	
	0.44	10.30	23.9/17.2	2.582	2.001	3.376	0.794	38.8		10.0	4.102	3.376	0.726	
			26.7/19.4	2.694	2.268	3.497	0.803	39.0		15.6	3.849	3.064	0.785	
			28.3/20.6	2.758	2.463	3.566	0.808	39.2		21.1	3.631	2.795	0.836	
			30.0/21.7	2.826	2.741	3.639	0.814	39.3		26.7	3.413	2.527	0.886	
	0.60	15.90	23.9/17.2	2.739	2.123	3.511	0.772	37.2		10.0	4.157	3.416	0.741	
			26.7/19.4	2.851	2.400	3.631	0.780	37.4		15.6	3.899	3.099	0.800	
			28.3/20.6	2.915	2.603	3.700	0.785	37.5		21.1	3.679	2.828	0.851	
			30.0/21.7	2.983	2.893	3.773	0.791	37.6		26.7	3.459	2.556	0.902	
37.8	0.32	5.50	23.9/17.2	2.196	1.735	3.089	0.892	46.1	32.2	10.0	4.038	3.314	0.725	
			26.7/19.4	2.308	1.985	3.210	0.902	46.4		15.6	3.788	3.006	0.782	
			28.3/20.6	2.372	2.159	3.280	0.907	46.6		21.1	3.573	2.741	0.832	
			30.0/21.7	2.440	2.416	3.353	0.913	46.8		26.7	3.360	2.478	0.881	
	0.44	10.30	23.9/17.2	2.404	1.899	3.258	0.854	44.2		All data is with 100% water (no antifreeze) and no pumping penalty. Unit kW data includes fan motor. Total Capacity Correction Factory (% by Weight)				
			26.7/19.4	2.516	2.164	3.380	0.864	44.4						
			28.3/20.6	2.580	2.348	3.449	0.869	44.5						
			30.0/21.7	2.648	2.621	3.523	0.875	44.7						
	0.60	15.90	23.9/17.2	2.551	2.015	3.376	0.825	42.6						
			26.7/19.4	2.667	2.294	3.501	0.834	42.8						
			28.3/20.6	2.734	2.488	3.573	0.839	42.9						
			30.0/21.7	2.805	2.777	3.649	0.844	43.0						
0.60	15.90	23.9/17.2	2.259	1.830	3.153	0.894	47.8							
		26.7/19.4	2.463	2.167	3.365	0.902	48.1							
		28.3/20.6	2.580	2.399	3.487	0.907	48.3							
		30.0/21.7	2.704	2.677	3.616	0.913	48.5							

All data is with 100% water (no antifreeze) and no pumping penalty. Unit kW data includes fan motor.

Total Capacity Correction Factory (% by Weight)

METHANOL	10%	15%	20%
Cooling	1.00	0.99	0.99
Heating	0.99	0.98	0.97

ETHANOL	10%	15%	20%
Cooling	1.00	1.00	1.00
Heating	0.99	0.98	0.97

PROPYLENE GLYCOL	15%	20%	25%
Cooling	0.98	0.97	0.96
Heating	0.96	0.95	0.93

Capacity Data

Split System Unit Size 013

Low Temperature Operation – Anti-freeze Require

Ent. Water. °C	Water-Flow M ³ /h	Pressure Drop kpa	COOLING						HEATING					
			Ent. Air Db/wb°C	Total Watts	Sensible Watts	Ht. Rej Watts	Unit kW	Lvg. Water. °C	Ent. Water. °C	Ent. Air °C	Total Watts	Ht. Abs Watts	Unit kW	
4.4	0.40	5.50	23.9/17.2	3.651	2.628	4.320	0.669	13.7	-4	10.0	2.613	1.959	0.653	
			26.7/19.4	3.786	2.953	4.461	0.675	14.0		15.6	2.485	1.780	0.705	
			28.3/20.6	3.864	3.207	4.541	0.678	14.2		21.1	2.372	1.623	0.749	
			30.0/21.7	3.946	3.551	4.627	0.681	14.3		26.7	2.262	1.469	0.793	
	0.60	11.00	23.9/17.2	3.976	2.863	4.616	0.640	11.0		10.0	2.648	1.983	0.665	
			26.7/19.4	4.126	3.218	4.772	0.646	11.2		15.6	2.518	1.800	0.718	
			28.3/20.6	4.212	3.496	4.862	0.650	11.4		21.1	2.405	1.642	0.764	
			30.0/21.7	4.303	3.873	4.956	0.654	11.5		26.7	2.294	1.484	0.809	
	0.80	16.60	23.9/17.2	4.020	2.894	4.643	0.623	9.4		10.0	2.684	2.008	0.677	
			26.7/19.4	4.180	3.260	4.808	0.628	9.6		15.6	2.552	1.821	0.731	
			28.3/20.6	4.271	3.545	4.902	0.631	9.7		21.1	2.439	1.661	0.778	
			30.0/21.7	4.368	3.931	5.002	0.634	9.8		26.7	2.326	1.500	0.826	
10.0	0.40	5.50	23.9/17.2	3.477	2.538	4.200	0.723	19.0	4.4	10.0	3.001	2.315	0.687	
			26.7/19.4	3.612	2.854	4.342	0.730	19.3		15.6	2.815	2.072	0.743	
			28.3/20.6	3.690	3.099	4.423	0.733	19.5		21.1	2.657	1.868	0.789	
			30.0/21.7	3.772	3.432	4.509	0.737	19.7		26.7	2.498	1.660	0.838	
	0.60	11.00	23.9/17.2	3.775	2.756	4.472	0.697	16.4		10.0	3.138	2.434	0.703	
			26.7/19.4	3.920	3.097	4.622	0.702	16.6		15.6	2.944	2.183	0.761	
			28.3/20.6	4.003	3.362	4.708	0.705	16.7		21.1	2.777	1.968	0.810	
			30.0/21.7	4.091	3.723	4.800	0.709	16.9		26.7	2.611	1.752	0.858	
	0.80	16.60	23.9/17.2	4.011	2.928	4.680	0.669	15.0		10.0	3.179	2.460	0.718	
			26.7/19.4	4.161	3.287	4.835	0.675	15.2		15.6	2.984	2.207	0.776	
			28.3/20.6	4.247	3.567	4.924	0.678	15.3		21.1	2.813	1.989	0.825	
			30.0/21.7	4.338	3.947	5.019	0.681	15.4		26.7	2.645	1.770	0.875	
21.1	0.40	5.50	23.9/17.2	3.159	2.370	4.050	0.891	29.8	10.0	10.0	3.494	2.761	0.733	
			26.7/19.4	3.278	2.655	4.176	0.899	30.1		15.6	3.277	2.484	0.793	
			28.3/20.6	3.345	2.877	4.248	0.903	30.2		21.1	3.091	2.248	0.843	
			30.0/21.7	3.417	3.109	4.325	0.908	30.4		26.7	2.907	2.013	0.894	
	0.60	11.00	23.9/17.2	3.469	2.602	4.326	0.856	27.3		10.0	3.652	2.900	0.752	
			26.7/19.4	3.587	2.906	4.450	0.863	27.5		15.6	3.426	2.613	0.814	
			28.3/20.6	3.655	3.143	4.522	0.867	27.6		21.1	3.233	2.367	0.866	
			30.0/21.7	3.727	3.391	4.598	0.871	27.7		26.7	3.039	2.123	0.916	
	0.80	16.60	23.9/17.2	3.613	2.710	4.447	0.834	25.9		10.0	3.700	2.933	0.767	
			26.7/19.4	3.750	3.038	4.591	0.841	26.0		15.6	3.471	2.642	0.829	
			28.3/20.6	3.829	3.293	4.674	0.845	26.1		21.1	3.276	2.395	0.881	
			30.0/21.7	3.912	3.560	4.761	0.849	26.2		26.7	3.079	2.144	0.935	
29.4	0.40	5.50	23.9/17.2	2.915	2.245	3.885	0.970	37.8	21.1	10.0	4.525	3.704	0.821	
			26.7/19.4	3.023	2.521	4.002	0.979	38.0		15.6	4.245	3.359	0.886	
			28.3/20.6	3.084	2.726	4.068	0.984	38.1		21.1	4.005	3.063	0.942	
			30.0/21.7	3.149	3.023	4.138	0.989	38.3		26.7	3.765	2.765	1.000	
	0.60	11.00	23.9/17.2	3.170	2.441	4.095	0.925	35.3		10.0	4.731	3.889	0.842	
			26.7/19.4	3.288	2.742	4.221	0.933	35.4		15.6	4.439	3.530	0.909	
			28.3/20.6	3.355	2.966	4.293	0.937	35.6		21.1	4.186	3.219	0.967	
			30.0/21.7	3.427	3.290	4.369	0.942	35.7		26.7	3.935	2.911	1.024	
	0.80	16.60	23.9/17.2	3.328	2.562	4.229	0.901	33.9		10.0	4.793	3.937	0.857	
			26.7/19.4	3.465	2.890	4.374	0.909	34.1		15.6	4.496	3.570	0.926	
			28.3/20.6	3.543	3.132	4.457	0.913	34.2		21.1	4.241	3.256	0.985	
			30.0/21.7	3.627	3.482	4.545	0.918	34.3		26.7	3.987	2.942	1.045	
32.2	0.40	5.50	23.9/17.2	2.801	2.171	3.808	1.007	40.4	29.4	10.0	5.046	4.167	0.879	
			26.7/19.4	2.912	2.452	3.929	1.016	40.6		15.6	4.734	3.784	0.950	
			28.3/20.6	2.976	2.658	3.997	1.021	40.8		21.1	4.465	3.456	1.010	
			30.0/21.7	3.044	2.952	4.070	1.026	40.9		26.7	4.198	3.129	1.069	
	0.60	11.00	23.9/17.2	3.062	2.373	4.032	0.970	38.0		10.0	5.275	4.376	0.899	
			26.7/19.4	3.174	2.672	4.152	0.979	38.2		15.6	4.949	3.977	0.972	
			28.3/20.6	3.237	2.891	4.221	0.984	38.2		21.1	4.670	3.634	1.036	
			30.0/21.7	3.305	3.206	4.294	0.989	38.4		26.7	4.388	3.291	1.097	
	0.80	16.60	23.9/17.2	3.247	2.516	4.189	0.942	36.7		10.0	5.345	4.427	0.918	
			26.7/19.4	3.358	2.827	4.309	0.951	36.8		15.6	5.014	4.023	0.991	
			28.3/20.6	3.422	3.056	4.378	0.956	36.9		21.1	4.731	3.676	1.054	
			30.0/21.7	3.489	3.385	4.451	0.961	37.0		26.7	4.448	3.330	1.118	
37.8	0.40	5.50	23.9/17.2	2.610	2.062	3.699	1.089	45.8	32.2	10.0	5.193	4.295	0.898	
			26.7/19.4	2.721	2.340	3.820	1.099	46.0		15.6	4.870	3.902	0.968	
			28.3/20.6	2.785	2.534	3.889	1.105	46.2		21.1	4.595	3.564	1.030	
			30.0/21.7	2.852	2.824	3.963	1.110	46.3		26.7	4.320	3.229	1.092	
	0.60	11.00	23.9/17.2	2.853	2.254	3.896	1.043	43.4		All data is with 100% water (no antifreeze) and no pumping penalty. Unit kW data includes fan motor. Total Capacity Correction Factory (% by Weight)				
			26.7/19.4	2.965	2.550	4.017	1.053	43.6						
			28.3/20.6	3.028	2.756	4.086	1.058	43.7						
			30.0/21.7	3.096	3.065	4.160	1.064	43.8						
	0.80	16.60	23.9/17.2	3.027	2.391	4.034	1.007	42.1						
			26.7/19.4	3.143	2.703	4.159	1.016	42.3						
			28.3/20.6	3.209	2.920	4.230	1.021	42.3						
			30.0/21.7	3.280	3.247	4.306	1.026	42.4						
43.3	0.80	16.60	23.9/17.2	2.709	2.194	3.800	1.091	47.4						
			26.7/19.4	2.912	2.563	4.012	1.100	47.6						
			28.3/20.6	3.028	2.816	4.133	1.105	47.7						
			30.0/21.7	3.152	3.120	4.262	1.110	47.9						

All data is with 100% water (no antifreeze) and no pumping penalty. Unit kW data includes fan motor.

Total Capacity Correction Factory (% by Weight)

METHANOL	10%	15%	20%
Cooling	1.00	0.99	0.99
Heating	0.99	0.98	0.97

ETHANOL	10%	15%	20%
Cooling	1.00	1.00	1.00
Heating	0.99	0.98	0.97

PROPYLENE GLYCOL	15%	20%	25%
Cooling	0.98	0.97	0.96
Heating	0.96	0.95	0.93

Split WSHP

Capacity Data

Split System Unit Size 016

Low Temperature Operation – Anti-freeze Require

Ent. Water. °C	Water-Flow M ³ /h	Pressure Drop kpa	COOLING						HEATING					
			Ent. Air Db/wb°C	Total Watts	Sensible Watts	Ht. Rej Watts	Unit kW	Lvg. Water. °C	Ent. Water. °C	Ent. Air °C	Total Watts	Ht. Abs Watts	Unit kW	
4.4	0.47	7.60	23.9/17.2	4.902	3.529	5.757	0.855	14.9	-4	10.0	3.002	2.210	0.792	
			26.7/19.4	5.047	3.936	5.907	0.861	15.2		15.6	2.857	2.003	0.855	
			28.3/20.6	5.129	4.257	5.993	0.864	15.4		21.1	2.730	1.822	0.908	
			30.0/21.7	5.217	4.696	6.085	0.867	15.5		26.7	2.605	1.643	0.962	
	0.68	13.80	23.9/17.2	5.340	3.844	6.157	0.818	12.2		10.0	3.043	2.237	0.806	
			26.7/19.4	5.500	4.290	6.324	0.825	12.4		15.6	2.896	2.026	0.870	
			28.3/20.6	5.592	4.641	6.420	0.828	12.5		21.1	2.768	1.842	0.926	
			30.0/21.7	5.689	5.120	6.521	0.833	12.6		26.7	2.642	1.660	0.981	
	1.10	22.10	23.9/17.2	5.402	3.889	6.198	0.796	9.2		10.0	3.085	2.265	0.820	
			26.7/19.4	5.573	4.347	6.374	0.801	9.4		15.6	2.935	2.049	0.886	
			28.3/20.6	5.670	4.706	6.475	0.805	9.5		21.1	2.807	1.863	0.944	
			30.0/21.7	5.774	5.196	6.582	0.808	9.5		26.7	2.679	1.678	1.001	
10.0	0.47	7.60	23.9/17.2	4.671	3.410	5.595	0.924	20.2	4.4	10.0	3.431	2.598	0.832	
			26.7/19.4	4.816	3.804	5.747	0.931	20.5		15.6	3.218	2.317	0.900	
			28.3/20.6	4.898	4.115	5.833	0.935	20.7		21.1	3.037	2.081	0.957	
			30.0/21.7	4.986	4.538	5.925	0.939	20.8		26.7	2.855	1.839	1.016	
	0.68	13.80	23.9/17.2	5.070	3.701	5.961	0.890	17.5		10.0	3.586	2.733	0.853	
			26.7/19.4	5.226	4.128	6.122	0.896	17.7		15.6	3.365	2.442	0.923	
			28.3/20.6	5.314	4.464	6.214	0.899	17.9		21.1	3.175	2.193	0.982	
			30.0/21.7	5.409	4.922	6.311	0.903	18.0		26.7	2.984	1.944	1.041	
	1.10	22.10	23.9/17.2	5.386	3.932	6.241	0.855	14.9		10.0	3.633	2.762	0.871	
			26.7/19.4	5.546	4.381	6.407	0.861	15.0		15.6	3.410	2.469	0.941	
			28.3/20.6	5.638	4.736	6.502	0.864	15.1		21.1	3.216	2.216	1.000	
			30.0/21.7	5.735	5.219	6.603	0.867	15.2		26.7	3.023	1.962	1.061	
21.1	0.47	7.60	23.9/17.2	4.243	3.182	5.381	1.138	30.9	10.0	10.0	3.994	3.105	0.889	
			26.7/19.4	4.369	3.539	5.516	1.147	31.2		15.6	3.746	2.785	0.961	
			28.3/20.6	4.441	3.819	5.592	1.152	31.3		21.1	3.533	2.511	1.022	
			30.0/21.7	4.518	4.111	5.674	1.157	31.5		26.7	3.322	2.239	1.084	
	0.68	13.80	23.9/17.2	4.654	3.490	5.748	1.094	28.4		10.0	4.174	3.262	0.912	
			26.7/19.4	4.780	3.872	5.881	1.101	28.5		15.6	3.916	2.930	0.986	
			28.3/20.6	4.852	4.173	5.958	1.105	28.6		21.1	3.695	2.645	1.050	
			30.0/21.7	4.929	4.485	6.039	1.110	28.7		26.7	3.474	2.363	1.111	
	1.10	22.10	23.9/17.2	4.852	3.639	5.918	1.066	25.7		10.0	4.229	3.300	0.930	
			26.7/19.4	4.999	4.049	6.072	1.073	25.8		15.6	3.967	2.963	1.004	
			28.3/20.6	5.083	4.372	6.160	1.077	25.9		21.1	3.744	2.676	1.068	
			30.0/21.7	5.172	4.707	6.254	1.081	26.0		26.7	3.519	2.385	1.133	
29.4	0.47	7.60	23.9/17.2	3.914	3.014	5.154	1.240	38.8	21.1	10.0	5.172	4.176	0.995	
			26.7/19.4	4.029	3.360	5.278	1.249	39.1		15.6	4.852	3.778	1.074	
			28.3/20.6	4.094	3.619	5.349	1.254	39.2		21.1	4.578	3.435	1.142	
			30.0/21.7	4.164	3.997	5.424	1.260	39.3		26.7	4.303	3.091	1.212	
	0.68	13.80	23.9/17.2	4.256	3.277	5.439	1.182	36.3		10.0	5.407	4.387	1.020	
			26.7/19.4	4.383	3.655	5.573	1.191	36.4		15.6	5.073	3.972	1.102	
			28.3/20.6	4.455	3.938	5.650	1.195	36.5		21.1	4.784	3.613	1.172	
			30.0/21.7	4.531	4.350	5.732	1.200	36.6		26.7	4.498	3.256	1.242	
	1.10	22.10	23.9/17.2	4.474	3.445	5.625	1.152	33.8		10.0	5.479	4.440	1.038	
			26.7/19.4	4.620	3.853	5.780	1.160	33.9		15.6	5.139	4.017	1.122	
			28.3/20.6	4.704	4.159	5.869	1.165	34.0		21.1	4.848	3.654	1.194	
			30.0/21.7	4.793	4.602	5.963	1.170	34.1		26.7	4.557	3.290	1.267	
32.2	0.47	7.60	23.9/17.2	3.764	2.917	5.051	1.287	41.4	29.4	10.0	5.768	4.702	1.065	
			26.7/19.4	3.883	3.270	5.180	1.296	41.7		15.6	5.411	4.260	1.151	
			28.3/20.6	3.951	3.528	5.253	1.302	41.8		21.1	5.104	3.880	1.224	
			30.0/21.7	4.023	3.903	5.331	1.307	42.0		26.7	4.799	3.503	1.296	
	0.68	13.80	23.9/17.2	4.111	3.186	5.350	1.240	39.0		10.0	6.030	4.939	1.090	
			26.7/19.4	4.230	3.561	5.479	1.249	39.1		15.6	5.657	4.478	1.179	
			28.3/20.6	4.298	3.838	5.552	1.254	39.2		21.1	5.337	4.082	1.255	
			30.0/21.7	4.370	4.239	5.630	1.260	39.3		26.7	5.016	3.686	1.330	
	1.10	22.10	23.9/17.2	4.356	3.376	5.560	1.204	36.5		10.0	6.110	4.997	1.113	
			26.7/19.4	4.475	3.768	5.688	1.214	36.6		15.6	5.731	4.530	1.201	
			28.3/20.6	4.543	4.056	5.762	1.219	36.7		21.1	5.407	4.129	1.278	
			30.0/21.7	4.615	4.476	5.839	1.225	36.8		26.7	5.083	3.728	1.355	
37.8	0.47	7.60	23.9/17.2	3.510	2.773	4.902	1.392	46.8	32.2	10.0	5.935	4.847	1.088	
			26.7/19.4	3.629	3.121	5.031	1.402	47.0		15.6	5.567	4.393	1.174	
			28.3/20.6	3.697	3.364	5.105	1.408	47.1		21.1	5.251	4.003	1.249	
			30.0/21.7	3.769	3.731	5.184	1.415	47.3		26.7	4.938	3.615	1.323	
	0.68	13.80	23.9/17.2	3.833	3.028	5.166	1.333	44.3		All data is with 100% water (no antifreeze) and no pumping penalty. Unit kW data includes fan motor. Total Capacity Correction Factory (% by Weight)	METHANOL	10%	15%	20%
			26.7/19.4	3.952	3.399	5.296	1.343	44.5			Cooling	1.00	0.99	0.99
			28.3/20.6	4.020	3.659	5.370	1.349	44.6			Heating	0.99	0.98	0.97
			30.0/21.7	4.093	4.052	5.448	1.355	44.7			ETHANOL	10%	15%	20%
	1.10	22.10	23.9/17.2	4.066	3.212	5.353	1.287	42.0			Cooling	1.00	1.00	1.00
			26.7/19.4	4.190	3.603	5.486	1.296	42.1			Heating	0.99	0.98	0.97
			28.3/20.6	4.261	3.877	5.562	1.302	42.1			PROPYLENE G LYCOL	15%	20%	25%
			30.0/21.7	4.336	4.293	5.644	1.307	42.2			Cooling	0.98	0.97	0.96
1.10	22.10	23.9/17.2	3.679	2.980	5.073	1.394	47.3	Heating	0.96		0.95	0.93		
		26.7/19.4	3.896	3.429	5.299	1.403	47.4							
		28.3/20.6	4.020	3.739	5.429	1.408	47.5							
		30.0/21.7	4.152	4.111	5.566	1.414	47.7							

Capacity Data

Split System Unit Size 019

Low Temperature Operation - Anti-freeze Require

Ent. Water. °C	Water-Flow M ³ /h	Pressure Drop kpa	COOLING						HEATING					
			Ent. Air Db/wb°C	Total Watts	Sensible Watts	Ht. Rej Watts	Unit kW	Lvg. Water. °C	Ent. Water. °C	Ent. Air °C	Total Watts	Ht. Abs Watts	Unit kW	
4.4	0.60	11.00	23.9/17.2	5.827	4.196	6.888	1.061	14.3	-4	10.0	4.060	3.004	1.056	
			26.7/19.4	5.962	4.650	7.028	1.066	14.5		15.6	3.863	2.724	1.139	
			28.3/20.6	6.039	5.012	7.108	1.069	14.6		21.1	3.691	2.480	1.211	
			30.0/21.7	6.120	5.508	7.193	1.072	14.7		26.7	3.521	2.238	1.283	
	0.91	20.70	23.9/17.2	6.349	4.571	7.364	1.015	11.4		10.0	4.116	3.041	1.075	
			26.7/19.4	6.498	5.068	7.519	1.022	11.5		15.6	3.915	2.755	1.161	
			28.3/20.6	6.583	5.464	7.608	1.025	11.6		21.1	3.742	2.508	1.234	
			30.0/21.7	6.673	6.006	7.702	1.029	11.7		26.7	3.570	2.262	1.308	
	1.30	33.80	23.9/17.2	6.426	4.627	7.414	0.988	9.3		10.0	4.172	3.078	1.094	
			26.7/19.4	6.585	5.136	7.578	0.993	9.4		15.6	3.968	2.786	1.182	
			28.3/20.6	6.675	5.540	7.671	0.996	9.5		21.1	3.794	2.536	1.258	
			30.0/21.7	6.771	6.094	7.771	0.999	9.5		26.7	3.621	2.286	1.334	
10.0	0.60	11.00	23.9/17.2	5.555	4.055	6.703	1.147	19.6	4.4	10.0	4.646	3.536	1.110	
			26.7/19.4	5.690	4.495	6.843	1.154	19.8		15.6	4.358	3.157	1.201	
			28.3/20.6	5.767	4.844	6.924	1.157	19.9		21.1	4.114	2.838	1.276	
			30.0/21.7	5.848	5.322	7.009	1.161	20.0		26.7	3.867	2.512	1.354	
	0.91	20.70	23.9/17.2	6.030	4.402	7.135	1.105	16.7		10.0	4.857	3.720	1.137	
			26.7/19.4	6.174	4.877	7.284	1.110	16.9		15.6	4.557	3.327	1.231	
			28.3/20.6	6.256	5.255	7.369	1.113	17.0		21.1	4.299	2.990	1.309	
			30.0/21.7	6.344	5.773	7.460	1.116	17.0		26.7	4.041	2.654	1.388	
	1.30	33.80	23.9/17.2	6.403	4.674	7.464	1.061	14.9		10.0	4.921	3.759	1.161	
			26.7/19.4	6.552	5.176	7.618	1.066	15.0		15.6	4.618	3.364	1.255	
			28.3/20.6	6.637	5.575	7.706	1.069	15.1		21.1	4.355	3.022	1.333	
			30.0/21.7	6.727	6.122	7.800	1.072	15.2		26.7	4.094	2.679	1.415	
21.1	0.60	11.00	23.9/17.2	5.044	3.783	6.457	1.413	30.4	10.0	10.0	5.409	4.223	1.185	
			26.7/19.4	5.161	4.181	6.582	1.421	30.5		15.6	5.073	3.791	1.282	
			28.3/20.6	5.228	4.496	6.653	1.425	30.6		21.1	4.785	3.421	1.363	
			30.0/21.7	5.299	4.822	6.729	1.430	30.7		26.7	4.499	3.054	1.445	
	0.91	20.70	23.9/17.2	5.528	4.146	6.886	1.357	27.6		10.0	5.653	4.437	1.216	
			26.7/19.4	5.645	4.573	7.009	1.364	27.7		15.6	5.304	3.988	1.315	
			28.3/20.6	5.712	4.913	7.080	1.368	27.8		21.1	5.004	3.604	1.400	
			30.0/21.7	5.783	5.263	7.155	1.372	27.9		26.7	4.704	3.223	1.481	
	1.30	33.80	23.9/17.2	5.770	4.328	7.092	1.322	25.8		10.0	5.728	4.488	1.240	
			26.7/19.4	5.906	4.784	7.235	1.329	25.9		15.6	5.373	4.034	1.339	
			28.3/20.6	5.984	5.146	7.317	1.333	25.9		21.1	5.071	3.647	1.424	
			30.0/21.7	6.067	5.521	7.404	1.337	26.0		26.7	4.765	3.254	1.511	
29.4	0.60	11.00	23.9/17.2	4.653	3.582	6.192	1.539	38.3	21.1	10.0	7.004	5.677	1.327	
			26.7/19.4	4.759	3.969	6.307	1.548	38.4		15.6	6.571	5.138	1.433	
			28.3/20.6	4.820	4.261	6.373	1.553	38.5		21.1	6.199	4.676	1.523	
			30.0/21.7	4.885	4.689	6.443	1.558	38.6		26.7	5.828	4.211	1.617	
	0.91	20.70	23.9/17.2	5.060	3.896	6.528	1.467	35.6		10.0	7.323	5.962	1.360	
			26.7/19.4	5.177	4.318	6.652	1.475	35.7		15.6	6.871	5.402	1.469	
			28.3/20.6	5.244	4.636	6.724	1.479	35.8		21.1	6.480	4.917	1.563	
			30.0/21.7	5.316	5.103	6.800	1.484	35.8		26.7	6.091	4.435	1.656	
	1.30	33.80	23.9/17.2	5.324	4.099	6.753	1.429	33.9		10.0	7.420	6.035	1.385	
			26.7/19.4	5.460	4.554	6.897	1.437	34.0		15.6	6.959	5.463	1.496	
			28.3/20.6	5.538	4.896	6.979	1.441	34.0		21.1	6.566	4.973	1.593	
			30.0/21.7	5.621	5.396	7.067	1.446	34.1		26.7	6.172	4.483	1.689	
32.2	0.60	11.00	23.9/17.2	4.478	3.470	6.075	1.598	40.9	29.4	10.0	7.811	6.390	1.421	
			26.7/19.4	4.588	3.863	6.194	1.606	41.1		15.6	7.328	5.793	1.535	
			28.3/20.6	4.651	4.154	6.263	1.611	41.2		21.1	6.912	5.280	1.632	
			30.0/21.7	4.718	4.577	6.335	1.616	41.3		26.7	6.499	4.771	1.728	
	0.91	20.70	23.9/17.2	4.886	3.787	6.425	1.539	38.3		10.0	8.166	6.712	1.454	
			26.7/19.4	4.996	4.207	6.544	1.548	38.4		15.6	7.661	6.090	1.572	
			28.3/20.6	5.059	4.518	6.612	1.553	38.4		21.1	7.229	5.554	1.674	
			30.0/21.7	5.126	4.973	6.684	1.558	38.5		26.7	6.793	5.019	1.774	
	1.30	33.80	23.9/17.2	5.174	4.010	6.669	1.495	36.6		10.0	8.274	6.790	1.484	
			26.7/19.4	5.285	4.450	6.788	1.504	36.7		15.6	7.761	6.159	1.602	
			28.3/20.6	5.348	4.776	6.856	1.509	36.7		21.1	7.323	5.619	1.704	
			30.0/21.7	5.415	5.252	6.929	1.514	36.8		26.7	6.885	5.078	1.807	
37.8	0.60	11.00	23.9/17.2	4.179	3.301	5.907	1.728	46.3	32.2	10.0	8.038	6.588	1.451	
			26.7/19.4	4.289	3.689	6.027	1.737	46.4		15.6	7.539	5.974	1.566	
			28.3/20.6	4.352	3.960	6.095	1.743	46.5		21.1	7.112	5.447	1.665	
			30.0/21.7	4.419	4.375	6.168	1.749	46.6		26.7	6.688	4.923	1.765	
	0.91	20.70	23.9/17.2	4.559	3.602	6.214	1.655	43.7		All data is with 100% water (no antifreeze) and no pumping penalty. Unit kW data includes fan motor. Total Capacity Correction Factory (% by Weight)				
			26.7/19.4	4.670	4.016	6.334	1.664	43.8						
			28.3/20.6	4.733	4.307	6.403	1.670	43.8						
			30.0/21.7	4.800	4.752	6.476	1.676	43.9						
	1.30	33.80	23.9/17.2	4.835	3.819	6.432	1.598	42.1						
			26.7/19.4	4.950	4.257	6.556	1.606	42.1						
			28.3/20.6	5.016	4.564	6.627	1.611	42.2						
			30.0/21.7	5.086	5.035	6.702	1.616	42.2						
43.3	1.30	33.80	23.9/17.2	4.416	3.577	6.145	1.729	47.4						
			26.7/19.4	4.618	4.064	6.356	1.738	47.5						
			28.3/20.6	4.733	4.402	6.476	1.743	47.6						
			30.0/21.7	4.855	4.807	6.604	1.748	47.7						

All data is with 100% water (no antifreeze) and no pumping penalty. Unit kW data includes fan motor.

Total Capacity Correction Factory (% by Weight)

	10%	15%	20%
METHANOL			
Cooling	1.00	0.99	0.99
Heating	0.99	0.98	0.97

	10%	15%	20%
ETHANOL			
Cooling	1.00	1.00	1.00
Heating	0.99	0.98	0.97

	15%	20%	25%
PROPYLENE GLYCOL			
Cooling	0.98	0.97	0.96
Heating	0.96	0.95	0.93

Split WSHP

Capacity Data

Split System Unit Size 024

Low Temperature Operation – Anti-freeze Require

Ent. Water. °C	Water-Flow M ³ /h	Pressure Drop kpa	COOLING						HEATING					
			Ent. Air Db/wb°C	Total Watts	Sensible Watts	Ht. Rej Watts	Unit kW	Lvg. Water. °C	Ent. Water. °C	Ent. Air °C	Total Watts	Ht. Abs Watts	Unit kW	
4.4	0.70	13.90	23.9/17.2	6.628	4.772	7.773	1.144	13.9	-4	10.0	4.492	3.337	1.155	
			26.7/19.4	6.763	5.275	7.912	1.150	14.1		15.6	4.273	3.027	1.246	
			28.3/20.6	6.839	5.677	7.992	1.153	14.2		21.1	4.082	2.757	1.324	
			30.0/21.7	6.921	6.229	8.077	1.156	14.3		26.7	3.893	2.490	1.403	
	1.10	26.30	23.9/17.2	7.222	5.200	8.318	1.096	10.9		10.0	4.553	3.378	1.175	
			26.7/19.4	7.371	5.749	8.472	1.102	11.0		15.6	4.331	3.062	1.269	
			28.3/20.6	7.456	6.188	8.561	1.105	11.1		21.1	4.139	2.789	1.350	
			30.0/21.7	7.546	6.791	8.655	1.109	11.2		26.7	3.948	2.517	1.431	
	1.30	41.90	23.9/17.2	7.312	5.264	8.377	1.065	9.9		10.0	4.615	3.419	1.196	
			26.7/19.4	7.470	5.827	8.541	1.071	10.0		15.6	4.389	3.097	1.293	
			28.3/20.6	7.560	6.275	8.634	1.074	10.1		21.1	4.196	2.820	1.376	
			30.0/21.7	7.656	6.891	8.733	1.077	10.2		26.7	4.003	2.544	1.459	
10.0	0.70	13.90	23.9/17.2	6.320	4.614	7.558	1.238	19.3	4.4	10.0	5.146	3.932	1.214	
			26.7/19.4	6.455	5.099	7.698	1.244	19.5		15.6	4.826	3.513	1.313	
			28.3/20.6	6.531	5.486	7.779	1.247	19.6		21.1	4.556	3.161	1.395	
			30.0/21.7	6.613	6.018	7.864	1.251	19.7		26.7	4.283	2.801	1.481	
	1.10	26.30	23.9/17.2	6.860	5.008	8.052	1.192	16.3		10.0	5.379	4.136	1.244	
			26.7/19.4	7.004	5.533	8.201	1.197	16.4		15.6	5.048	3.702	1.346	
			28.3/20.6	7.086	5.952	8.286	1.200	16.5		21.1	4.762	3.330	1.432	
			30.0/21.7	7.173	6.528	8.376	1.203	16.5		26.7	4.476	2.959	1.517	
	1.30	41.90	23.9/17.2	7.284	5.317	8.428	1.144	15.6		10.0	5.450	4.180	1.270	
			26.7/19.4	7.432	5.871	8.582	1.150	15.7		15.6	5.115	3.743	1.372	
			28.3/20.6	7.517	6.314	8.670	1.153	15.7		21.1	4.823	3.365	1.458	
			30.0/21.7	7.607	6.923	8.763	1.156	15.8		26.7	4.535	2.987	1.547	
21.1	0.70	13.90	23.9/17.2	5.737	4.303	7.262	1.524	30.0	10.0	10.0	5.991	4.694	1.429	
			26.7/19.4	5.854	4.742	7.386	1.532	30.2		15.6	5.619	4.217	1.402	
			28.3/20.6	5.921	5.092	7.458	1.536	30.3		21.1	5.300	3.808	1.491	
			30.0/21.7	5.992	5.453	7.533	1.541	30.4		26.7	4.983	3.403	1.580	
	1.10	26.30	23.9/17.2	6.286	4.714	7.750	1.464	27.2		10.0	6.261	4.932	1.329	
			26.7/19.4	6.403	5.186	7.874	1.471	27.3		15.6	5.874	4.436	1.438	
			28.3/20.6	6.470	5.564	7.945	1.475	27.3		21.1	5.542	4.012	1.531	
			30.0/21.7	6.541	5.952	8.020	1.479	27.4		26.7	5.210	3.591	1.620	
	1.30	41.90	23.9/17.2	6.564	4.923	7.990	1.426	26.4		10.0	6.344	4.988	1.356	
			26.7/19.4	6.700	5.427	8.133	1.433	26.5		15.6	5.951	4.486	1.465	
			28.3/20.6	6.778	5.829	8.215	1.437	26.5		21.1	5.616	4.059	1.557	
			30.0/21.7	6.860	6.243	8.301	1.441	26.6		26.7	5.278	3.625	1.653	
29.4	0.70	13.90	23.9/17.2	5.292	4.075	6.952	1.660	37.9	21.1	10.0	7.757	6.306	1.452	
			26.7/19.4	5.398	4.502	7.067	1.669	38.1		15.6	7.278	5.711	1.567	
			28.3/20.6	5.459	4.826	7.133	1.674	38.2		21.1	6.866	5.200	1.666	
			30.0/21.7	5.524	5.303	7.203	1.679	38.2		26.7	6.455	4.686	1.768	
	1.10	26.30	23.9/17.2	5.756	4.432	7.339	1.583	35.1		10.0	8.111	6.623	1.488	
			26.7/19.4	5.873	4.898	7.463	1.590	35.2		15.6	7.610	6.003	1.607	
			28.3/20.6	5.940	5.251	7.535	1.595	35.3		21.1	7.177	5.468	1.709	
			30.0/21.7	6.011	5.770	7.610	1.599	35.3		26.7	6.747	4.935	1.811	
	1.30	41.90	23.9/17.2	6.059	4.665	7.600	1.542	34.4		10.0	8.218	6.704	1.514	
			26.7/19.4	6.195	5.166	7.744	1.549	34.5		15.6	7.708	6.072	1.636	
			28.3/20.6	6.273	5.545	7.826	1.554	34.6		21.1	7.272	5.530	1.742	
			30.0/21.7	6.355	6.101	7.914	1.558	34.6		26.7	6.836	4.988	1.847	
32.2	0.70	13.90	23.9/17.2	5.095	3.949	6.818	1.723	40.6	29.4	10.0	8.651	7.098	1.554	
			26.7/19.4	5.205	4.383	6.937	1.732	40.7		15.6	8.117	6.438	1.679	
			28.3/20.6	5.268	4.704	7.005	1.737	40.8		21.1	7.656	5.871	1.785	
			30.0/21.7	5.335	5.175	7.077	1.742	40.9		26.7	7.198	5.308	1.890	
	1.10	26.30	23.9/17.2	5.557	4.307	7.217	1.660	37.8		10.0	9.045	7.454	1.590	
			26.7/19.4	5.667	4.772	7.336	1.669	37.9		15.6	8.485	6.767	1.719	
			28.3/20.6	5.730	5.117	7.404	1.674	38.0		21.1	8.006	6.175	1.831	
			30.0/21.7	5.797	5.623	7.476	1.679	38.0		26.7	7.524	5.584	1.940	
	1.30	41.90	23.9/17.2	5.884	4.560	7.496	1.613	37.2		10.0	9.164	7.541	1.623	
			26.7/19.4	5.994	5.047	7.615	1.621	37.2		15.6	8.596	6.844	1.752	
			28.3/20.6	6.057	5.409	7.683	1.626	37.3		21.1	8.111	6.247	1.864	
			30.0/21.7	6.124	5.940	7.755	1.632	37.3		26.7	7.625	5.649	1.976	
37.8	0.70	13.90	23.9/17.2	4.756	3.757	6.620	1.864	45.9	32.2	10.0	8.903	7.316	1.587	
			26.7/19.4	4.866	4.185	6.740	1.874	46.1		15.6	8.350	6.638	1.712	
			28.3/20.6	4.929	4.486	6.808	1.879	46.2		21.1	7.877	6.056	1.821	
			30.0/21.7	4.996	4.946	6.881	1.885	46.3		26.7	7.407	5.477	1.930	
	1.10	26.30	23.9/17.2	5.187	4.098	6.972	1.785	43.3		All data is with 100% water (no antifreeze) and no pumping penalty. Unit kW data includes fan motor. Total Capacity Correction Factory (% by Weight)	METHANOL	10%	15%	20%
			26.7/19.4	5.298	4.556	7.092	1.795	43.3			Cooling	1.00	0.99	0.99
			28.3/20.6	5.361	4.878	7.161	1.800	43.4			Heating	0.99	0.98	0.97
			30.0/21.7	5.428	5.373	7.233	1.806	43.5			ETHANOL	10%	15%	20%
	1.30	41.90	23.9/17.2	5.500	4.345	7.224	1.723	42.6			Cooling	1.00	1.00	1.00
			26.7/19.4	5.615	4.829	7.347	1.732	42.7			Heating	0.99	0.98	0.97
			28.3/20.6	5.681	5.170	7.418	1.737	42.7			PROPYLENE GLYCOL	15%	20%	25%
			30.0/21.7	5.751	5.693	7.493	1.742	42.8			Cooling	0.98	0.97	0.96
43.3	41.90	23.9/17.2	5.044	4.086	6.910	1.866	47.9	Heating	0.96		0.95	0.93		
		26.7/19.4	5.246	4.616	7.120	1.874	48.0							
		28.3/20.6	5.361	4.985	7.240	1.879	48.1							
		30.0/21.7	5.483	5.428	7.367	1.884	48.2							

Capacity Data

Split System Unit Size 027

Low Temperature Operation – Anti-freeze Require

Ent. Water. °C	Water-Flow M ³ /h	Pressure Drop kpa	COOLING						HEATING																	
			Ent. Air Db/wb°C	Total Watts	Sensible Watts	Ht. Rej Watts	Unit kW	Lvg. Water. °C	Ent. Water. °C	Ent. Air °C	Total Watts	Ht. Abs Watts	Unit kW													
4.4	0.85	22.70	23.9/17.2	8.003	5.762	9.440	1.437	13.9	-4	10.0	5.504	4.052	1.452													
			26.7/19.4	8.137	6.347	9.580	1.443	14.1		15.6	5.238	3.672	1.567													
			28.3/20.6	8.214	6.817	9.659	1.446	14.2		21.1	5.005	3.340	1.665													
			30.0/21.7	8.295	7.465	9.744	1.449	14.3		26.7	4.776	3.012	1.763													
	1.31	34.50	23.9/17.2	8.720	6.279	10.097	1.376	11.0		10.0	5.579	4.102	1.478													
			26.7/19.4	8.869	6.918	10.251	1.383	11.1		15.6	5.309	3.713	1.596													
			28.3/20.6	8.954	7.431	10.340	1.386	11.2		21.1	5.075	3.378	1.697													
			30.0/21.7	9.044	8.139	10.433	1.390	11.2		26.7	4.843	3.044	1.799													
	1.70	52.80	23.9/17.2	8.831	6.359	10.170	1.338	9.5		10.0	5.656	4.152	1.504													
			26.7/19.4	8.989	7.012	10.333	1.344	9.6		15.6	5.381	3.756	1.625													
			28.3/20.6	9.079	7.536	10.426	1.347	9.7		21.1	5.146	3.416	1.730													
			30.0/21.7	9.175	8.258	10.525	1.350	9.7		26.7	4.911	3.076	1.835													
10.0	0.85	22.70	23.9/17.2	7.633	5.572	9.188	1.555	19.3	4.4	10.0	6.289	4.763	1.526													
			26.7/19.4	7.767	6.136	9.328	1.561	19.4		15.6	5.899	4.248	1.651													
			28.3/20.6	7.844	6.589	9.408	1.564	19.5		21.1	5.569	3.814	1.754													
			30.0/21.7	7.925	7.212	9.493	1.568	19.6		26.7	5.234	3.372	1.862													
	1.31	34.50	23.9/17.2	8.284	6.047	9.781	1.497	16.4		10.0	6.575	5.011	1.563													
			26.7/19.4	8.428	6.658	9.929	1.502	16.5		15.6	6.169	4.477	1.692													
			28.3/20.6	8.510	7.148	10.014	1.505	16.6		21.1	5.820	4.020	1.800													
			30.0/21.7	8.597	7.823	10.105	1.508	16.6		26.7	5.471	3.563	1.908													
	1.70	52.80	23.9/17.2	8.794	6.420	10.232	1.437	15.2		10.0	6.661	5.065	1.597													
			26.7/19.4	8.943	7.065	10.385	1.443	15.3		15.6	6.252	4.527	1.725													
			28.3/20.6	9.028	7.583	10.473	1.446	15.3		21.1	5.895	4.062	1.833													
			30.0/21.7	9.118	8.297	10.566	1.449	15.3		26.7	5.542	3.597	1.945													
21.1	0.85	22.70	23.9/17.2	6.928	5.196	8.842	1.915	30.0	10.0	10.0	7.322	5.692	1.630													
			26.7/19.4	7.044	5.706	8.967	1.922	30.2		15.6	6.868	5.105	1.763													
			28.3/20.6	7.111	6.115	9.038	1.927	30.2		21.1	6.477	4.603	1.875													
			30.0/21.7	7.182	6.536	9.113	1.931	30.3		26.7	6.090	4.104	1.986													
	1.31	34.50	23.9/17.2	7.586	5.690	9.425	1.839	27.3		10.0	7.653	5.981	1.671													
			26.7/19.4	7.703	6.239	9.549	1.846	27.4		15.6	7.179	5.371	1.808													
			28.3/20.6	7.770	6.682	9.619	1.849	27.4		21.1	6.774	4.850	1.924													
			30.0/21.7	7.840	7.135	9.694	1.854	27.5		26.7	6.368	4.332	2.036													
	1.70	52.80	23.9/17.2	7.926	5.945	9.718	1.791	26.0		10.0	7.754	6.049	1.704													
			26.7/19.4	8.062	6.530	9.860	1.798	26.1		15.6	7.273	5.432	1.841													
			28.3/20.6	8.140	7.000	9.942	1.802	26.1		21.1	6.864	4.907	1.957													
			30.0/21.7	8.222	7.482	10.028	1.806	26.2		26.7	6.451	4.373	2.078													
29.4	0.85	22.70	23.9/17.2	6.389	4.920	8.475	2.085	38.0	21.1	10.0	9.481	7.656	1.825													
			26.7/19.4	6.495	5.417	8.589	2.094	38.1		15.6	8.895	6.925	1.970													
			28.3/20.6	6.556	5.796	8.655	2.099	38.2		21.1	8.392	6.298	2.094													
			30.0/21.7	6.621	6.356	8.725	2.104	38.2		26.7	7.889	5.666	2.223													
	1.31	34.50	23.9/17.2	6.950	5.351	8.938	1.988	35.3		10.0	9.913	8.043	1.870													
			26.7/19.4	7.067	5.893	9.062	1.996	35.3		15.6	9.301	7.281	2.020													
			28.3/20.6	7.133	6.306	9.133	2.000	35.4		21.1	8.771	6.623	2.148													
			30.0/21.7	7.204	6.916	9.209	2.005	35.4		26.7	8.246	5.969	2.277													
	1.70	52.80	23.9/17.2	7.319	5.636	9.256	1.936	34.1		10.0	10.044	8.141	1.904													
			26.7/19.4	7.455	6.218	9.399	1.944	34.2		15.6	9.421	7.364	2.057													
			28.3/20.6	7.533	6.659	9.481	1.948	34.2		21.1	8.888	6.698	2.190													
			30.0/21.7	7.615	7.311	9.568	1.953	34.2		26.7	8.355	6.032	2.322													
32.2	0.85	22.70	23.9/17.2	6.154	4.769	8.318	2.165	40.6	29.4	10.0	10.574	8.621	1.953													
			26.7/19.4	6.264	5.274	8.437	2.173	40.7		15.6	9.920	7.810	2.111													
			28.3/20.6	6.327	5.650	8.505	2.178	40.8		21.1	9.357	7.114	2.244													
			30.0/21.7	6.393	6.202	8.577	2.183	40.9		26.7	8.798	6.421	2.376													
	1.31	34.50	23.9/17.2	6.709	5.199	8.794	2.085	38.0		10.0	11.054	9.056	1.999													
			26.7/19.4	6.819	5.741	8.913	2.094	38.1		15.6	10.371	8.210	2.161													
			28.3/20.6	6.882	6.145	8.981	2.099	38.1		21.1	9.785	7.484	2.302													
			30.0/21.7	6.948	6.740	9.053	2.104	38.1		26.7	9.196	6.757	2.439													
	1.70	52.80	23.9/17.2	7.101	5.503	9.127	2.026	36.8		10.0	11.201	9.160	2.040													
			26.7/19.4	7.211	6.072	9.246	2.035	36.9		15.6	10.506	8.304	2.202													
			28.3/20.6	7.274	6.496	9.313	2.040	36.9		21.1	9.913	7.570	2.343													
			30.0/21.7	7.341	7.120	9.385	2.045	36.9		26.7	9.320	6.836	2.484													
37.8	0.85	22.70	23.9/17.2	5.747	4.540	8.088	2.341	46.0	32.2	10.0	10.882	8.887	1.995													
			26.7/19.4	5.857	5.037	8.208	2.351	46.1		15.6	10.206	8.053	2.152													
			28.3/20.6	5.920	5.387	8.276	2.356	46.2		21.1	9.628	7.338	2.289													
			30.0/21.7	5.986	5.927	8.349	2.362	46.2		26.7	9.053	6.627	2.426													
	1.31	34.50	23.9/17.2	6.265	4.949	8.507	2.242	43.4		All data is with 100% water (no antifreeze) and no pumping penalty. Unit kW data includes fan motor. Total Capacity Correction Factory (% by Weight)	<table border="1"> <tr> <th>METHANOL</th> <th>10%</th> <th>15%</th> <th>20%</th> </tr> <tr> <td>Cooling</td> <td>1.00</td> <td>0.99</td> <td>0.99</td> </tr> <tr> <td>Heating</td> <td>0.99</td> <td>0.98</td> <td>0.97</td> </tr> </table>				METHANOL	10%	15%	20%	Cooling	1.00	0.99	0.99	Heating	0.99	0.98	0.97
			METHANOL	10%	15%	20%																				
			Cooling	1.00	0.99	0.99																				
			Heating	0.99	0.98	0.97																				
	26.7/19.4	6.375	5.482	8.627	2.252	43.5	<table border="1"> <tr> <th>ETHANOL</th> <th>10%</th> <th>15%</th> <th>20%</th> </tr> <tr> <td>Cooling</td> <td>1.00</td> <td>1.00</td> <td>1.00</td> </tr> <tr> <td>Heating</td> <td>0.99</td> <td>0.98</td> <td>0.97</td> </tr> </table>				ETHANOL	10%	15%	20%	Cooling	1.00	1.00	1.00	Heating	0.99	0.98	0.97				
	ETHANOL	10%	15%	20%																						
	Cooling	1.00	1.00	1.00																						
	Heating	0.99	0.98	0.97																						
28.3/20.6	6.438	5.858	8.695	2.257	43.5	<table border="1"> <tr> <th>PROPYLENE GLYCOL</th> <th>15%</th> <th>20%</th> <th>25%</th> </tr> <tr> <td>Cooling</td> <td>0.98</td> <td>0.97</td> <td>0.96</td> </tr> <tr> <td>Heating</td> <td>0.96</td> <td>0.95</td> <td>0.93</td> </tr> </table>					PROPYLENE GLYCOL	15%	20%	25%	Cooling	0.98	0.97	0.96	Heating	0.96	0.95	0.93				
PROPYLENE GLYCOL	15%	20%	25%																							
Cooling	0.98	0.97	0.96																							
Heating	0.96	0.95	0.93																							
30.0/21.7	6.504	6.439	8.768	2.263	43.6																					
1.70	52.80	23.9/17.2	6.642	5.247	8.807	2.165	42.3																			
		26.7/19.4	6.757	5.811	8.930	2.173	42.3																			
		28.3/20.6	6.822	6.208	9.001	2.178	42.4																			
		30.0/21.7	6.892	6.823	9.076	2.183	42.4																			
43.3	1.70	52.80	23.9/17.2	6.122	4.959	8.465	2.343	47.6																		
			26.7/19.4	6.323	5.564	8.674	2.351	47.7																		
			28.3/20.6	6.438	5.987	8.794	2.356	47.7																		
			30.0/21.7	6.560	6.494	8.921	2.362	47.8																		

Capacity Data

Split System Unit Size 030

Low Temperature Operation – Anti-freeze Require

Ent. Water. °C	Water-Flow M ³ /h	Pressure Drop kpa	COOLING						HEATING				
			Ent. Air Db/wb°C	Total Watts	Sensible Watts	Ht. Rej Watts	Unit kW	Lvg. Water. °C	Ent. Water. °C	Ent. Air °C	Total Watts	Ht. Abs Watts	Unit kW
4.4	0.88	21.40	23.9/17.2	9.262	6.669	10.849	1.587	15.0	-4	10.0	6.038	4.520	1.518
			26.7/19.4	9.396	7.329	10.988	1.592	15.1		15.6	5.742	4.105	1.638
			28.3/20.6	9.472	7.862	11.068	1.595	15.2		21.1	5.483	3.743	1.741
			30.0/21.7	9.554	8.598	11.152	1.599	15.3		26.7	5.228	3.385	1.843
	1.34	42.10	23.9/17.2	10.093	7.267	11.613	1.520	11.9		10.0	6.120	4.575	1.545
			26.7/19.4	10.241	7.988	11.767	1.526	12.0		15.6	5.820	4.152	1.668
			28.3/20.6	10.326	8.570	11.856	1.530	12.0		21.1	5.560	3.786	1.774
			30.0/21.7	10.416	9.374	11.949	1.534	12.1		26.7	5.302	3.421	1.880
	2.00	66.90	23.9/17.2	10.223	7.361	11.701	1.478	9.4		10.0	6.204	4.632	1.572
			26.7/19.4	10.381	8.097	11.864	1.483	9.5		15.6	5.898	4.199	1.699
			28.3/20.6	10.471	8.691	11.957	1.486	9.5		21.1	5.637	3.829	1.808
			30.0/21.7	10.567	9.510	12.056	1.489	9.6		26.7	5.376	3.458	1.918
10.0	0.88	21.40	23.9/17.2	8.836	6.450	10.552	1.717	20.3	4.4	10.0	6.933	5.337	1.596
			26.7/19.4	8.969	7.086	10.692	1.723	20.4		15.6	6.502	4.777	1.726
			28.3/20.6	9.046	7.598	10.772	1.727	20.5		21.1	6.138	4.304	1.834
			30.0/21.7	9.127	8.306	10.857	1.730	20.6		26.7	5.770	3.823	1.947
	1.34	42.10	23.9/17.2	9.589	7.000	11.241	1.653	17.2		10.0	7.247	5.613	1.635
			26.7/19.4	9.732	7.688	11.390	1.658	17.3		15.6	6.800	5.031	1.769
			28.3/20.6	9.814	8.244	11.475	1.661	17.4		21.1	6.415	4.534	1.882
			30.0/21.7	9.901	9.010	11.565	1.664	17.4		26.7	6.030	4.036	1.994
	2.00	66.90	23.9/17.2	10.178	7.430	11.766	1.587	15.1		10.0	7.342	5.673	1.669
			26.7/19.4	10.327	8.158	11.919	1.592	15.1		15.6	6.891	5.088	1.804
			28.3/20.6	10.411	8.745	12.007	1.595	15.2		21.1	6.498	4.582	1.916
			30.0/21.7	10.501	9.556	12.100	1.599	15.2		26.7	6.109	4.076	2.033
21.1	0.88	21.40	23.9/17.2	8.018	6.013	10.132	2.114	31.0	10.0	10.0	8.071	6.367	1.704
			26.7/19.4	8.134	6.589	10.256	2.122	31.1		15.6	7.570	5.727	1.843
			28.3/20.6	8.201	7.053	10.327	2.126	31.2		21.1	7.140	5.180	1.960
			30.0/21.7	8.272	7.527	10.403	2.131	31.3		26.7	6.713	4.637	2.077
	1.34	42.10	23.9/17.2	8.777	6.583	10.808	2.031	28.0		10.0	8.435	6.688	1.747
			26.7/19.4	8.894	7.204	10.931	2.037	28.1		15.6	7.914	6.023	1.890
			28.3/20.6	8.960	7.706	11.002	2.041	28.2		21.1	7.467	5.455	2.012
			30.0/21.7	9.031	8.218	11.076	2.045	28.2		26.7	7.020	4.891	2.129
	2.00	66.90	23.9/17.2	9.174	6.881	11.152	1.978	25.9		10.0	8.547	6.765	1.782
			26.7/19.4	9.310	7.541	11.295	1.985	26.0		15.6	8.017	6.092	1.925
			28.3/20.6	9.387	8.073	11.376	1.989	26.0		21.1	7.566	5.520	2.046
			30.0/21.7	9.469	8.617	11.462	1.993	26.0		26.7	7.111	4.939	2.172
29.4	0.88	21.40	23.9/17.2	7.394	5.694	9.697	2.303	38.9	21.1	10.0	10.451	8.543	1.908
			26.7/19.4	7.500	6.255	9.812	2.312	39.0		15.6	9.805	7.746	2.059
			28.3/20.6	7.561	6.684	9.877	2.317	39.1		21.1	9.251	7.061	2.190
			30.0/21.7	7.625	7.320	9.947	2.322	39.1		26.7	8.696	6.372	2.324
	1.34	42.10	23.9/17.2	8.043	6.193	10.239	2.195	36.0		10.0	10.927	8.971	1.955
			26.7/19.4	8.160	6.805	10.363	2.203	36.0		15.6	10.252	8.141	2.111
			28.3/20.6	8.227	7.272	10.434	2.207	36.1		21.1	9.669	7.423	2.246
			30.0/21.7	8.297	7.965	10.509	2.212	36.1		26.7	9.089	6.709	2.380
	2.00	66.90	23.9/17.2	8.474	6.525	10.613	2.138	34.0		10.0	11.072	9.082	1.990
			26.7/19.4	8.610	7.181	10.756	2.146	34.0		15.6	10.385	8.234	2.150
			28.3/20.6	8.687	7.680	10.838	2.151	34.1		21.1	9.797	7.508	2.289
			30.0/21.7	8.770	8.419	10.925	2.155	34.1		26.7	9.209	6.781	2.428
32.2	0.88	21.40	23.9/17.2	7.124	5.521	9.514	2.391	41.5	29.4	10.0	11.655	9.613	2.042
			26.7/19.4	7.234	6.091	9.633	2.399	41.6		15.6	10.935	8.728	2.207
			28.3/20.6	7.296	6.516	9.700	2.404	41.7		21.1	10.314	7.969	2.346
			30.0/21.7	7.363	7.142	9.772	2.409	41.7		26.7	9.698	7.213	2.484
	1.34	42.10	23.9/17.2	7.764	6.017	10.067	2.303	38.7		10.0	12.185	10.095	2.090
			26.7/19.4	7.874	6.630	10.185	2.312	38.7		15.6	11.432	9.173	2.259
			28.3/20.6	7.936	7.087	10.253	2.317	38.8		21.1	10.786	8.380	2.406
			30.0/21.7	8.003	7.763	10.325	2.322	38.8		26.7	10.136	7.587	2.549
	2.00	66.90	23.9/17.2	8.216	6.367	10.454	2.238	36.7		10.0	12.346	10.213	2.133
			26.7/19.4	8.326	7.010	10.572	2.246	36.7		15.6	11.581	9.278	2.302
			28.3/20.6	8.389	7.491	10.640	2.251	36.8		21.1	10.927	8.477	2.450
			30.0/21.7	8.455	8.202	10.712	2.256	36.8		26.7	10.273	7.676	2.597
37.8	0.88	21.40	23.9/17.2	6.654	5.257	9.240	2.586	46.8	32.2	10.0	11.995	9.909	2.085
			26.7/19.4	6.764	5.817	9.359	2.595	46.9		15.6	11.250	8.999	2.250
			28.3/20.6	6.827	6.213	9.428	2.601	47.0		21.1	10.612	8.219	2.393
			30.0/21.7	6.894	6.825	9.500	2.607	47.1		26.7	9.979	7.443	2.536
	1.34	42.10	23.9/17.2	7.252	5.729	9.728	2.476	44.0		10.0	12.185	10.095	2.090
			26.7/19.4	7.362	6.331	9.848	2.486	44.1		15.6	11.432	9.173	2.259
			28.3/20.6	7.424	6.756	9.916	2.491	44.2		21.1	10.786	8.380	2.406
			30.0/21.7	7.491	7.416	9.988	2.497	44.2		26.7	10.136	7.587	2.549
	2.00	66.90	23.9/17.2	7.688	6.073	10.078	2.391	42.1		10.0	12.346	10.213	2.133
			26.7/19.4	7.803	6.710	10.202	2.399	42.2		15.6	11.581	9.278	2.302
			28.3/20.6	7.868	7.160	10.272	2.404	42.2		21.1	10.927	8.477	2.450
			30.0/21.7	7.938	7.858	10.347	2.409	42.2		26.7	10.273	7.676	2.597
2.00	66.90	23.9/17.2	7.109	5.758	9.696	2.587	47.5	10.0	11.995	9.909	2.085		
		26.7/19.4	7.310	6.433	9.906	2.596	47.6	15.6	11.250	8.999	2.250		
		28.3/20.6	7.424	6.905	10.025	2.601	47.6	21.1	10.612	8.219	2.393		
		30.0/21.7	7.546	7.471	10.152	2.606	47.7	26.7	9.979	7.443	2.536		

All data is with 100% water (no antifreeze) and no pumping penalty. Unit kW data includes fan motor.

Total Capacity Correction Factory (% by Weight)

METHANO	L	10%	15%	20%
Cooling		1.00	0.99	0.99
Heating		0.99	0.98	0.97

ETHANO	L	10%	15%	20%
Cooling		1.00	1.00	1.00
Heating		0.99	0.98	0.97

PROPYLENE GLYCOL		15%	20%	25%
Cooling		0.98	0.97	0.96
Heating		0.96	0.95	0.93

Capacity Data

Split System Unit Size 036

Low Temperature Operation - Anti-freeze Require

Ent. Water. °C	Water-Flow M ³ /h	Pressure Drop kpa	COOLING						HEATING										
			Ent. Air Db/wb°C	Total Watts	Sensible Watts	Ht. Rej Watts	Unit kW	Lvg. Water. °C	Ent. Water. °C	Ent. Air °C	Total Watts	Ht. Abs Watts	Unit kW						
4.4	21.40	21.40	1.17	23.9/17.2	10.408	7.493	12.130	1.722	13.3	-4	10.0	7.240	5.531	1.709					
			1.17	26.7/19.4	10.541	8.222	12.269	1.728	13.4						15.6	6.881	5.036	1.844	
			1.17	28.3/20.6	10.618	8.813	12.348	1.731	13.5						21.1	6.565	4.605	1.960	
			1.17	30.0/21.7	10.699	9.629	12.432	1.734	13.5						26.7	6.255	4.179	2.076	
	40.70	40.70	40.70	1.72	23.9/17.2	11.342	8.166	12.991	1.650		10.9	10.0	7.339	5.599	1.740				
				1.72	26.7/19.4	11.490	8.962	13.145	1.656		11.0					15.6	6.973	5.095	1.879
				1.72	28.3/20.6	11.574	9.607	13.234	1.659		11.0					21.1	6.656	4.658	1.998
				1.72	30.0/21.7	11.664	10.498	13.327	1.663		11.1					26.7	6.342	4.225	2.118
	65.50	65.50	65.50	2.30	23.9/17.2	11.489	8.272	13.093	1.604		9.3	10.0	7.439	5.668	1.771				
				2.30	26.7/19.4	11.647	9.084	13.256	1.609		9.4					15.6	7.067	5.154	1.913
				2.30	28.3/20.6	11.737	9.742	13.349	1.612		9.4					21.1	6.749	4.712	2.037
				2.30	30.0/21.7	11.832	10.649	13.448	1.615		9.4					26.7	6.431	4.271	2.160
10.0	21.40	21.40	1.17	23.9/17.2	9.929	7.248	11.792	1.863	18.7	4.4	10.0	8.363	6.566	1.797					
			1.17	26.7/19.4	10.063	7.950	11.932	1.869	18.8						15.6	7.844	5.900	1.943	
			1.17	28.3/20.6	10.139	8.517	12.012	1.873	18.8						21.1	7.404	5.339	2.065	
			1.17	30.0/21.7	10.220	9.301	12.097	1.877	18.9						26.7	6.960	4.768	2.192	
	40.70	40.70	40.70	1.72	23.9/17.2	10.775	7.866	12.569	1.793		16.3	10.0	8.742	6.902	1.841				
				1.72	26.7/19.4	10.918	8.626	12.717	1.799		16.4					15.6	8.203	6.211	1.992
				1.72	28.3/20.6	11.000	9.240	12.802	1.802		16.4					21.1	7.739	5.620	2.119
				1.72	30.0/21.7	11.087	10.089	12.892	1.805		16.4					26.7	7.275	5.028	2.246
	65.50	65.50	65.50	2.30	23.9/17.2	11.437	8.349	13.160	1.722		14.9	10.0	8.857	6.977	1.880				
				2.30	26.7/19.4	11.585	9.152	13.313	1.728		15.0					15.6	8.313	6.282	2.031
				2.30	28.3/20.6	11.670	9.803	13.400	1.731		15.0					21.1	7.839	5.681	2.158
				2.30	30.0/21.7	11.760	10.701	13.493	1.734		15.0					26.7	7.369	5.079	2.290
21.1	21.40	21.40	1.17	23.9/17.2	9.009	6.757	11.304	2.295	29.4	10.0	10.0	9.736	7.817	1.919					
			1.17	26.7/19.4	9.126	7.392	11.428	2.302	29.5						15.6	9.132	7.057	2.075	
			1.17	28.3/20.6	9.192	7.905	11.499	2.307	29.6						21.1	8.613	6.406	2.207	
			1.17	30.0/21.7	9.263	8.429	11.574	2.311	29.6						26.7	8.098	5.760	2.339	
	40.70	40.70	40.70	1.72	23.9/17.2	9.861	7.396	12.064	2.204		27.1	10.0	10.175	8.208	1.968				
				1.72	26.7/19.4	9.977	8.081	12.187	2.210		27.2					15.6	9.546	7.417	2.129
				1.72	28.3/20.6	10.044	8.638	12.258	2.214		27.2					21.1	9.007	6.741	2.266
				1.72	30.0/21.7	10.114	9.204	12.333	2.218		27.3					26.7	8.468	6.070	2.397
	65.50	65.50	65.50	2.30	23.9/17.2	10.309	7.732	12.456	2.147		25.8	10.0	10.310	8.303	2.007				
				2.30	26.7/19.4	10.445	8.460	12.598	2.153		25.8					15.6	9.671	7.503	2.168
				2.30	28.3/20.6	10.522	9.049	12.679	2.157		25.8					21.1	9.127	6.822	2.305
				2.30	30.0/21.7	10.604	9.650	12.765	2.161		25.9					26.7	8.578	6.131	2.446
29.4	21.40	21.40	1.17	23.9/17.2	8.308	6.398	10.808	2.499	37.3	21.1	10.0	12.607	10.458	2.148					
			1.17	26.7/19.4	8.414	7.018	10.922	2.508	37.4						15.6	11.828	9.509	2.319	
			1.17	28.3/20.6	8.475	7.492	10.988	2.513	37.5						21.1	11.159	8.693	2.466	
			1.17	30.0/21.7	8.539	8.198	11.057	2.518	37.5						26.7	10.490	7.873	2.617	
	40.70	40.70	40.70	1.72	23.9/17.2	9.038	6.959	11.420	2.382		35.1	10.0	13.181	10.979	2.202				
				1.72	26.7/19.4	9.155	7.635	11.544	2.390		35.2					15.6	12.367	9.989	2.378
				1.72	28.3/20.6	9.221	8.151	11.615	2.394		35.2					21.1	11.663	9.134	2.529
				1.72	30.0/21.7	9.292	8.920	11.691	2.399		35.2					26.7	10.964	8.284	2.681
	65.50	65.50	65.50	2.30	23.9/17.2	9.525	7.334	11.845	2.321		33.8	10.0	13.356	11.115	2.241				
				2.30	26.7/19.4	9.660	8.057	11.988	2.328		33.9					15.6	12.527	10.105	2.422
				2.30	28.3/20.6	9.738	8.608	12.070	2.333		33.9					21.1	11.818	9.240	2.578
				2.30	30.0/21.7	9.820	9.427	12.157	2.337		33.9					26.7	11.109	8.375	2.734
32.2	21.40	21.40	1.17	23.9/17.2	8.006	6.205	10.600	2.594	40.0	29.4	10.0	14.060	11.760	2.300					
			1.17	26.7/19.4	8.116	6.833	10.718	2.603	40.1						15.6	13.191	10.706	2.485	
			1.17	28.3/20.6	8.178	7.303	10.786	2.608	40.1						21.1	12.442	9.801	2.642	
			1.17	30.0/21.7	8.245	7.998	10.858	2.613	40.2						26.7	11.698	8.900	2.798	
	40.70	40.70	40.70	1.72	23.9/17.2	8.723	6.761	11.223	2.499		37.8	10.0	14.699	12.345	2.354				
				1.72	26.7/19.4	8.833	7.437	11.341	2.508		37.9					15.6	13.790	11.246	2.544
				1.72	28.3/20.6	8.896	7.944	11.409	2.513		37.9					21.1	13.011	10.301	2.710
				1.72	30.0/21.7	8.962	8.694	11.480	2.518		37.9					26.7	12.227	9.356	2.871
	65.50	65.50	65.50	2.30	23.9/17.2	9.230	7.153	11.658	2.428		36.6	10.0	14.894	12.491	2.402				
				2.30	26.7/19.4	9.340	7.864	11.777	2.437		36.6					15.6	13.970	11.377	2.593
				2.30	28.3/20.6	9.403	8.397	11.844	2.442		36.6					21.1	13.181	10.422	2.759
				2.30	30.0/21.7	9.469	9.185	11.916	2.447		36.7					26.7	12.392	9.467	2.925
37.8	21.40	21.40	1.17	23.9/17.2	7.480	5.909	10.286	2.806	45.4	32.2	10.0	14.469	12.121	2.349					
			1.17	26.7/19.4	7.590	6.527	10.405	2.816	45.4						15.6	13.571	11.036	2.534	
			1.17	28.3/20.6	7.652	6.964	10.473	2.821	45.5						21.1	12.802	10.106	2.695	
			1.17	30.0/21.7	7.719	7.642	10.546	2.827	45.6						26.7	12.038	9.181	2.856	
	40.70	40.70	40.70	1.72	23.9/17.2	8.149	6.438	10.837	2.687		43.2	10.0	14.699	12.345	2.354				
				1.72	26.7/19.4	8.259	7.103	10.956	2.697		43.3					15.6	13.790	11.246	2.544
				1.72	28.3/20.6	8.322	7.573	11.024	2.702		43.3					21.1	13.011	10.301	2.710
				1.72	30.0/21.7	8.389	8.305	11.097	2.708		43.3					26.7	12.227	9.356	2.871
	65.50	65.50	65.50	2.30	23.9/17.2	8.639	6.825	11.233	2.594		42.0	10.0	14.894	12.491	2.402				
				2.30	26.7/19.4	8.754	7.528	11.357	2.603		42.0					15.6	13.970	11.377	2.593
				2.30	28.3/20.6	8.819	8.026	11.427	2.608		42.1					21.1	13.181	10.422	2.759
				2.30	30.0/21.7	8.889	8.800	11.502	2.613		42.1					26.7	12.392	9.467	2.925
43.3	65.50	65.50	2.30	23.9/17.2	8.007	6.486	10.814	2.807	47.3	10.0	14.469	12.121	2.349						
			2.30	26.7/19.4	8.207	7.222	11.023	2.816	47.4					15.6	13.571	11.036	2.534		
			2.30	28.3/20.6	8.322	7.739	11.143	2.821	47.5					21.1	12.802	10.106	2.695		
			2.30	30.0/21.7	8.444	8.359	11.270	2.826	47.5					26.7	12.038	9.181	2.856		

All data is with 100% water (no antifreeze) and no pumping penalty. Unit kW data includes fan motor.

Total Capacity Correction Factory (% by Weight)

	10%	15%	20%
METHANOL			
Cooling	1.00	0.99	0.99
Heating	0.99	0.98	0.97

	10%	15%	20%
ETHANOL			
Cooling	1.00	1.00	1.00
Heating	0.99	0.98	0.97

	15%	20%	25%
PROPYLENE GLYCOL			
Cooling	0.98	0.97	0.96
Heating	0.96	0.95	0.93

Split WSHP

Capacity Data

Split System Unit Size 043

Low Temperature Operation – Anti-freeze Require

Ent. Water. °C	Water-Flow M ³ /h	Pressure Drop kpa	COOLING						HEATING				
			Ent. Air Db/wb°C	Total Watts	Sensible Watts	Ht. Rej Watts	Unit kW	Lvg. Water. °C	Ent. Water. °C	Ent. Air °C	Total Watts	Ht. Abs Watts	Unit kW
4.4	1.35	20.70	23.9/17.2	12.468	8.977	14.608	2.140	13.3	-4	10.0	7.870	5.852	2.018
			26.7/19.4	12.601	9.829	14.746	2.145	13.4		15.6	7.506	5.319	2.188
			28.3/20.6	12.678	10.522	14.826	2.148	13.5		21.1	7.184	4.854	2.330
			30.0/21.7	12.759	11.483	14.910	2.151	13.5		26.7	6.862	4.395	2.466
	2.00	40.70	23.9/17.2	13.588	9.783	15.613	2.025	10.9		10.0	7.985	5.924	2.061
			26.7/19.4	13.735	10.714	15.767	2.032	11.0		15.6	7.611	5.380	2.230
			28.3/20.6	13.820	11.470	15.855	2.035	11.0		21.1	7.283	4.910	2.373
			30.0/21.7	13.909	12.519	15.948	2.039	11.1		26.7	6.958	4.443	2.515
	2.60	66.90	23.9/17.2	13.767	9.912	15.735	1.969	9.3		10.0	8.101	5.997	2.105
			26.7/19.4	13.924	10.861	15.898	1.974	9.4		15.6	7.716	5.442	2.274
			28.3/20.6	14.014	11.632	15.991	1.977	9.4		21.1	7.383	4.967	2.416
			30.0/21.7	14.109	12.698	16.090	1.980	9.4		26.7	7.055	4.491	2.564
10.0	1.35	20.70	23.9/17.2	11.897	8.685	14.184	2.287	18.7	4.4	10.0	8.934	6.922	2.012
			26.7/19.4	12.030	9.504	14.324	2.293	18.8		15.6	8.379	6.203	2.176
			28.3/20.6	12.107	10.170	14.403	2.297	18.8		21.1	7.910	5.597	2.312
			30.0/21.7	12.188	11.091	14.488	2.300	18.9		26.7	7.435	4.981	2.455
	2.00	40.70	23.9/17.2	12.910	9.424	15.111	2.201	16.3		10.0	9.339	7.278	2.061
			26.7/19.4	13.053	10.312	15.259	2.207	16.4		15.6	8.763	6.533	2.230
			28.3/20.6	13.134	11.033	15.344	2.210	16.4		21.1	8.267	5.895	2.373
			30.0/21.7	13.221	12.031	15.434	2.213	16.4		26.7	7.771	5.256	2.515
	2.60	66.90	23.9/17.2	13.702	10.002	15.816	2.114	14.9		10.0	9.462	7.357	2.105
			26.7/19.4	13.850	10.941	15.969	2.119	15.0		15.6	8.881	6.606	2.274
			28.3/20.6	13.934	11.705	16.056	2.122	15.0		21.1	8.374	5.958	2.416
			30.0/21.7	14.024	12.762	16.149	2.125	15.0		26.7	7.873	5.309	2.564
21.1	1.35	20.70	23.9/17.2	10.793	8.095	13.610	2.817	29.4	10.0	10.0	10.401	8.252	2.148
			26.7/19.4	10.909	8.837	13.734	2.824	29.5		15.6	9.755	7.432	2.323
			28.3/20.6	10.976	9.439	13.805	2.829	29.6		21.1	9.201	6.730	2.471
			30.0/21.7	11.046	10.052	13.880	2.833	29.6		26.7	8.651	6.033	2.619
	2.00	40.70	23.9/17.2	11.810	8.857	14.515	2.705	27.1		10.0	10.870	8.667	2.203
			26.7/19.4	11.926	9.660	14.637	2.712	27.2		15.6	10.198	7.815	2.383
			28.3/20.6	11.992	10.313	14.708	2.715	27.2		21.1	9.622	7.085	2.537
			30.0/21.7	12.063	10.977	14.782	2.719	27.3		26.7	9.046	6.362	2.684
	2.60	66.90	23.9/17.2	12.351	9.263	14.986	2.635	25.8		10.0	11.014	8.767	2.247
			26.7/19.4	12.486	10.114	15.128	2.642	25.8		15.6	10.331	7.904	2.427
			28.3/20.6	12.563	10.805	15.209	2.646	25.8		21.1	9.750	7.170	2.580
			30.0/21.7	12.646	11.507	15.295	2.650	25.9		26.7	9.163	6.424	2.739
29.4	1.35	20.70	23.9/17.2	9.953	7.664	13.021	3.068	37.3	21.1	10.0	13.468	11.062	2.405
			26.7/19.4	10.059	8.389	13.136	3.077	37.4		15.6	12.635	10.039	2.597
			28.3/20.6	10.119	8.945	13.201	3.082	37.5		21.1	11.921	9.160	2.761
			30.0/21.7	10.184	9.776	13.270	3.087	37.5		26.7	11.206	8.276	2.930
	2.00	40.70	23.9/17.2	10.827	8.337	13.752	2.924	35.1		10.0	14.081	11.615	2.465
			26.7/19.4	10.944	9.127	13.876	2.932	35.2		15.6	13.212	10.549	2.662
			28.3/20.6	11.010	9.733	13.946	2.936	35.2		21.1	12.459	9.628	2.832
			30.0/21.7	11.081	10.638	14.022	2.941	35.2		26.7	11.713	8.712	3.001
	2.60	66.90	23.9/17.2	11.414	8.789	14.263	2.849	33.8		10.0	14.268	11.758	2.509
			26.7/19.4	11.550	9.632	14.406	2.856	33.9		15.6	13.382	10.671	2.711
			28.3/20.6	11.627	10.278	14.488	2.861	33.9		21.1	12.625	9.738	2.886
			30.0/21.7	11.709	11.241	14.574	2.865	33.9		26.7	11.867	8.806	3.061
32.2	1.35	20.70	23.9/17.2	9.593	7.435	12.777	3.184	40.0	29.4	10.0	15.020	12.445	2.575
			26.7/19.4	9.703	8.170	12.896	3.193	40.1		15.6	14.092	11.309	2.783
			28.3/20.6	9.765	8.720	12.963	3.198	40.1		21.1	13.292	10.334	2.957
			30.0/21.7	9.832	9.537	13.035	3.203	40.2		26.7	12.497	9.364	3.132
	2.00	40.70	23.9/17.2	10.450	8.098	13.518	3.068	37.8		10.0	15.702	13.067	2.635
			26.7/19.4	10.559	8.891	13.636	3.077	37.9		15.6	14.732	11.883	2.848
			28.3/20.6	10.622	9.485	13.703	3.082	37.9		21.1	13.900	10.866	3.034
			30.0/21.7	10.688	10.368	13.775	3.087	37.9		26.7	13.062	9.848	3.214
	2.60	66.90	23.9/17.2	11.055	8.568	14.036	2.981	36.6		10.0	15.910	13.221	2.690
			26.7/19.4	11.164	9.401	14.154	2.990	36.6		15.6	14.924	12.021	2.903
			28.3/20.6	11.227	10.026	14.222	2.994	36.6		21.1	14.081	10.992	3.089
			30.0/21.7	11.294	10.955	14.293	3.000	36.7		26.7	13.238	9.964	3.275
37.8	1.35	20.70	23.9/17.2	8.965	7.082	12.409	3.445	45.4	32.2	10.0	15.457	12.828	2.629
			26.7/19.4	9.074	7.804	12.529	3.454	45.4		15.6	14.497	11.660	2.837
			28.3/20.6	9.137	8.315	12.597	3.460	45.5		21.1	13.676	10.658	3.018
			30.0/21.7	9.204	9.112	12.669	3.465	45.6		26.7	12.859	9.661	3.198
	2.00	40.70	23.9/17.2	9.764	7.714	13.064	3.299	43.2		10.0	15.702	13.067	2.635
			26.7/19.4	9.874	8.492	13.183	3.309	43.3		15.6	14.732	11.883	2.848
			28.3/20.6	9.937	9.042	13.251	3.314	43.3		21.1	13.900	10.866	3.034
			30.0/21.7	10.003	9.903	13.323	3.320	43.3		26.7	13.062	9.848	3.214
	2.60	66.90	23.9/17.2	10.351	8.177	13.535	3.184	42.0		10.0	15.910	13.221	2.690
			26.7/19.4	10.465	9.000	13.658	3.193	42.0		15.6	14.924	12.021	2.903
			28.3/20.6	10.530	9.583	13.728	3.198	42.1		21.1	14.081	10.992	3.089
			30.0/21.7	10.600	10.494	13.803	3.203	42.1		26.7	13.238	9.964	3.275
43.3	66.90	23.9/17.2	9.622	7.794	13.068	3.446	47.3	10.0	15.457	12.828	2.629		
		26.7/19.4	9.822	8.643	13.277	3.455	47.4	15.6	14.497	11.660	2.837		
		28.3/20.6	9.937	9.241	13.396	3.460	47.5	21.1	13.676	10.658	3.018		
		30.0/21.7	10.058	9.957	13.523	3.465	47.5	26.7	12.859	9.661	3.198		

All data is with 100% water (no antifreeze) and no pumping penalty. Unit kW data includes fan motor.

Total Capacity Correction Factory (% by Weight)

	10%	15%	20%
METHANOL			
Cooling	1.00	0.99	0.99
Heating	0.99	0.98	0.97

	10%	15%	20%
ETHANOL			
Cooling	1.00	1.00	1.00
Heating	0.99	0.98	0.97

	15%	20%	25%
PROPYLENE GLYCOL			
Cooling	0.98	0.97	0.96
Heating	0.96	0.95	0.93

Capacity Data

Split System Unit Size 052

Low Temperature Operation – Anti-freeze Require

Ent. Water. °C	Water-Flow M ³ /h	Pressure Drop kpa	COOLING						HEATING				
			Ent. Air Db/wb°C	Total Watts	Sensible Watts	Ht. Rej Watts	Unit kW	Lvg. Water. °C	Ent. Water. °C	Ent. Air °C	Total Watts	Ht. Abs Watts	Unit kW
4.4	1.60 1.60 1.60 1.60	16.50	23.9/17.2	14.301	10.296	16.792	2.491	13.4	-4	10.0	9.961	7.453	2.508
			26.7/19.4	14.434	11.259	16.930	2.496	13.5		15.6	9.474	6.768	2.706
			28.3/20.6	14.510	12.043	17.009	2.499	13.5		21.1	9.046	6.171	2.876
			30.0/21.7	14.591	13.132	17.094	2.502	13.6		26.7	8.626	5.580	3.046
	2.40 2.40 2.40 2.40	32.40	23.9/17.2	15.585	11.222	17.972	2.387	10.8		10.0	10.097	7.544	2.552
			26.7/19.4	15.733	12.272	18.126	2.393	10.9		15.6	9.601	6.845	2.756
			28.3/20.6	15.817	13.128	18.214	2.397	10.9		21.1	9.173	6.241	2.931
			30.0/21.7	15.907	14.316	18.307	2.400	11.0		26.7	8.747	5.640	3.107
	3.10 3.10 3.10 3.10	53.80	23.9/17.2	15.793	11.371	18.113	2.320	9.4		10.0	10.235	7.637	2.597
			26.7/19.4	15.950	12.441	18.275	2.325	9.5		15.6	9.731	6.924	2.807
			28.3/20.6	16.040	13.313	18.368	2.328	9.5		21.1	9.300	6.313	2.988
			30.0/21.7	16.135	14.522	18.466	2.331	9.5		26.7	8.870	5.701	3.169
10.0	1.60 1.60 1.60 1.60	16.50	23.9/17.2	13.647	9.962	16.342	2.695	18.8	4.4	10.0	11.435	8.799	2.636
			26.7/19.4	13.780	10.887	16.482	2.701	18.9		15.6	10.725	7.874	2.851
			28.3/20.6	13.857	11.640	16.561	2.705	18.9		21.1	10.125	7.095	3.030
			30.0/21.7	13.938	12.683	16.646	2.708	18.9		26.7	9.517	6.301	3.216
	2.40 2.40 2.40 2.40	32.40	23.9/17.2	14.809	10.810	17.402	2.594	16.2		10.0	11.954	9.254	2.701
			26.7/19.4	14.951	11.812	17.550	2.599	16.3		15.6	11.217	8.294	2.923
			28.3/20.6	15.033	12.628	17.635	2.602	16.3		21.1	10.582	7.473	3.109
			30.0/21.7	15.120	13.759	17.725	2.605	16.4		26.7	9.947	6.652	3.295
	3.10 3.10 3.10 3.10	53.80	23.9/17.2	15.716	11.473	18.207	2.491	15.1		10.0	12.111	9.353	2.758
			26.7/19.4	15.864	12.532	18.360	2.496	15.1		15.6	11.367	8.387	2.980
			28.3/20.6	15.948	13.396	18.447	2.499	15.1		21.1	10.719	7.552	3.166
			30.0/21.7	16.038	14.594	18.540	2.502	15.1		26.7	10.077	6.717	3.360
21.1	1.60 1.60 1.60 1.60	16.50	23.9/17.2	12.380	9.285	15.699	3.319	29.5	10.0	10.0	13.313	10.498	2.815
			26.7/19.4	12.496	10.122	15.823	3.327	29.6		15.6	12.487	9.442	3.044
			28.3/20.6	12.562	10.804	15.894	3.331	29.6		21.1	11.777	8.539	3.238
			30.0/21.7	12.633	11.496	15.969	3.336	29.7		26.7	11.074	7.642	3.431
	2.40 2.40 2.40 2.40	32.40	23.9/17.2	13.543	10.157	16.731	3.187	27.1		10.0	13.914	11.027	2.887
			26.7/19.4	13.659	11.064	16.853	3.194	27.1		15.6	13.053	9.930	3.123
			28.3/20.6	13.726	11.804	16.924	3.198	27.2		21.1	12.316	8.992	3.324
			30.0/21.7	13.796	12.555	16.998	3.202	27.2		26.7	11.579	8.062	3.517
	3.10 3.10 3.10 3.10	53.80	23.9/17.2	14.167	10.625	17.272	3.105	25.9		10.0	14.098	11.154	2.944
			26.7/19.4	14.302	11.585	17.414	3.112	25.9		15.6	13.224	10.044	3.180
			28.3/20.6	14.379	12.366	17.495	3.116	26.0		21.1	12.480	9.099	3.381
			30.0/21.7	14.462	13.160	17.581	3.120	26.0		26.7	11.729	8.140	3.589
29.4	1.60 1.60 1.60 1.60	16.50	23.9/17.2	11.416	8.790	15.032	3.616	37.5	21.1	10.0	17.238	14.087	3.152
			26.7/19.4	11.522	9.609	15.146	3.624	37.5		15.6	16.173	12.771	3.403
			28.3/20.6	11.582	10.238	15.211	3.629	37.6		21.1	15.259	11.641	3.617
			30.0/21.7	11.646	11.180	15.281	3.634	37.6		26.7	14.344	10.504	3.840
	2.40 2.40 2.40 2.40	32.40	23.9/17.2	12.419	9.563	15.865	3.446	35.1		10.0	18.024	14.793	3.231
			26.7/19.4	12.535	10.454	15.989	3.454	35.1		15.6	16.911	13.422	3.489
			28.3/20.6	12.602	11.140	16.060	3.458	35.2		21.1	15.948	12.238	3.711
			30.0/21.7	12.672	12.165	16.135	3.463	35.2		26.7	14.992	11.060	3.933
	3.10 3.10 3.10 3.10	53.80	23.9/17.2	13.095	10.083	16.452	3.357	34.0		10.0	18.263	14.975	3.288
			26.7/19.4	13.230	11.034	16.595	3.365	34.0		15.6	17.129	13.576	3.553
			28.3/20.6	13.308	11.764	16.676	3.369	34.0		21.1	16.160	12.378	3.782
			30.0/21.7	13.390	12.854	16.763	3.374	34.0		26.7	15.190	11.179	4.011
32.2	1.60 1.60 1.60 1.60	16.50	23.9/17.2	11.005	8.529	14.757	3.753	40.1	29.4	10.0	19.225	15.851	3.374
			26.7/19.4	11.114	9.358	14.875	3.761	40.2		15.6	18.037	14.391	3.646
			28.3/20.6	11.177	9.981	14.943	3.766	40.2		21.1	17.013	13.138	3.875
			30.0/21.7	11.243	10.906	15.015	3.771	40.3		26.7	15.996	11.891	4.105
	2.40 2.40 2.40 2.40	32.40	23.9/17.2	11.985	9.288	15.601	3.616	37.8		10.0	20.099	16.646	3.453
			26.7/19.4	12.095	10.184	15.719	3.624	37.8		15.6	18.856	15.124	3.732
			28.3/20.6	12.157	10.856	15.786	3.629	37.9		21.1	17.791	13.816	3.976
			30.0/21.7	12.224	11.857	15.858	3.634	37.9		26.7	16.720	12.508	4.212
	3.10 3.10 3.10 3.10	53.80	23.9/17.2	12.678	9.825	16.191	3.513	36.7		10.0	20.365	16.841	3.524
			26.7/19.4	12.787	10.767	16.309	3.521	36.7		15.6	19.102	15.299	3.804
			28.3/20.6	12.850	11.475	16.376	3.526	36.7		21.1	18.024	13.976	4.047
			30.0/21.7	12.917	12.529	16.448	3.532	36.8		26.7	16.945	12.654	4.291
37.8	1.60 1.60 1.60 1.60	16.50	23.9/17.2	10.286	8.126	14.345	4.059	45.5	32.2	10.0	19.785	16.339	3.446
			26.7/19.4	10.395	8.940	14.464	4.069	45.6		15.6	18.556	14.838	3.718
			28.3/20.6	10.458	9.517	14.532	4.074	45.6		21.1	17.505	13.551	3.954
			30.0/21.7	10.524	10.419	14.604	4.080	45.6		26.7	16.460	12.270	4.191
	2.40 2.40 2.40 2.40	32.40	23.9/17.2	11.201	8.849	15.089	3.888	43.2		10.0	20.999	16.646	3.453
			26.7/19.4	11.310	9.727	15.208	3.898	43.2		15.6	18.856	15.124	3.732
			28.3/20.6	11.373	10.349	15.276	3.903	43.3		21.1	17.791	13.816	3.976
			30.0/21.7	11.439	11.325	15.348	3.909	43.3		26.7	16.720	12.508	4.212
	3.10 3.10 3.10 3.10	53.80	23.9/17.2	11.873	9.380	15.626	3.753	42.1		10.0	20.365	16.841	3.524
			26.7/19.4	11.987	10.309	15.748	3.761	42.2		15.6	19.102	15.299	3.804
			28.3/20.6	12.053	10.968	15.819	3.766	42.2		21.1	18.024	13.976	4.047
			30.0/21.7	12.122	12.001	15.893	3.771	42.2		26.7	16.945	12.654	4.291
43.3	3.10 3.10 3.10 3.10	53.80	23.9/17.2	11.059	8.957	15.119	4.061	47.5	32.2	10.0	19.785	16.339	3.446
			26.7/19.4	11.259	9.908	15.328	4.069	47.6		15.6	18.556	14.838	3.718
			28.3/20.6	11.373	10.577	15.447	4.074	47.6		21.1	17.505	13.551	3.954
			30.0/21.7	11.494	11.379	15.574	4.079	47.6		26.7	16.460	12.270	4.191

All data is with 100% water (no antifreeze) and no pumping penalty. Unit kW data includes fan motor.

Total Capacity Correction Factory (% by Weight)

	10%	15%	20%
METHANOL			
Cooling	1.00	0.99	0.99
Heating	0.99	0.98	0.97

	10%	15%	20%
ETHANOL			
Cooling	1.00	1.00	1.00
Heating	0.99	0.98	0.97

	15%	20%	25%
PROPYLENE GLYCOL			
Cooling	0.98	0.97	0.96
Heating	0.96	0.95	0.93

Split WSHP

Capacity Data

Split System Unit Size 062

Low Temperature Operation - Anti-freeze Require

Ent. Water. °C	Water-Flow M ³ /h	Pressure Drop kpa	COOLING						HEATING				
			Ent. Air Db/wb°C	Total Watts	Sensible Watts	Ht. Rej Watts	Unit kW	Lvg. Water. °C	Ent. Water. °C	Ent. Air °C	Total Watts	Ht. Abs Watts	Unit kW
4.4	1.80 1.80 1.80 1.80	13.10	23.9/17.2	16.705	12.027	19.421	2.716	13.7	-4	10.0 15.6 21.1 26.7	12.781 12.159 11.612 11.075	9.514 8.634 7.866 7.108	3.267 3.525 3.746 3.968
			26.7/19.4	16.838	13.134	19.559	2.721	13.7					
			28.3/20.6	16.914	14.039	19.638	2.724	13.8					
			30.0/21.7	16.995	15.296	19.722	2.727	13.8					
	2.71 2.71 2.71 2.71	26.20	23.9/17.2	18.206	13.108	20.809	2.603	11.0		10.0 15.6 21.1 26.7	12.956 12.323 11.774 11.231	9.631 8.733 7.956 7.184	3.325 3.590 3.818 4.047
			26.7/19.4	18.354	14.316	20.962	2.609	11.1					
			28.3/20.6	18.438	15.304	21.050	2.612	11.1					
			30.0/21.7	18.528	16.675	21.144	2.616	11.1					
	3.60 3.60 3.60 3.60	42.70	23.9/17.2	18.450	13.284	20.980	2.529	9.4		10.0 15.6 21.1 26.7	13.133 12.489 11.939 11.389	9.749 8.832 8.047 7.261	3.384 3.656 3.892 4.128
			26.7/19.4	18.607	14.514	21.142	2.535	9.4					
			28.3/20.6	18.697	15.519	21.235	2.538	9.5					
			30.0/21.7	18.792	16.913	21.333	2.541	9.5					
10.0	1.80 1.80 1.80 1.80	13.10	23.9/17.2	15.943	11.638	18.881	2.938	19.0	4.4	10.0 15.6 21.1 26.7	14.652 13.742 12.972 12.194	11.218 10.028 9.025 8.004	3.434 3.714 3.947 4.190
			26.7/19.4	16.076	12.700	19.021	2.945	19.1					
			28.3/20.6	16.152	13.568	19.100	2.948	19.1					
			30.0/21.7	16.233	14.772	19.185	2.952	19.2					
	2.71 2.71 2.71 2.71	26.20	23.9/17.2	17.299	12.629	20.127	2.828	16.4		10.0 15.6 21.1 26.7	15.316 14.372 13.558 12.745	11.799 10.565 9.509 8.452	3.518 3.807 4.050 4.292
			26.7/19.4	17.442	13.779	20.275	2.833	16.4					
			28.3/20.6	17.524	14.720	20.360	2.836	16.5					
			30.0/21.7	17.610	16.025	20.450	2.839	16.5					
	3.60 3.60 3.60 3.60	42.70	23.9/17.2	18.359	13.402	21.075	2.716	15.0		10.0 15.6 21.1 26.7	15.518 14.564 13.733 12.911	11.925 10.682 9.609 8.535	3.592 3.882 4.124 4.376
			26.7/19.4	18.506	14.620	21.227	2.721	15.1					
			28.3/20.6	18.590	15.616	21.315	2.724	15.1					
			30.0/21.7	18.680	16.999	21.407	2.727	15.1					
21.1	1.80 1.80 1.80 1.80	13.10	23.9/17.2	14.461	10.846	18.080	3.619	29.7	10.0	10.0 15.6 21.1 26.7	17.057 15.999 15.089 14.188	13.390 12.033 10.871 9.718	3.667 3.966 4.218 4.470
			26.7/19.4	14.577	11.808	18.204	3.627	29.8					
			28.3/20.6	14.644	12.594	18.275	3.631	29.8					
			30.0/21.7	14.714	13.390	18.350	3.636	29.9					
	2.71 2.71 2.71 2.71	26.20	23.9/17.2	15.817	11.863	19.292	3.475	27.2		10.0 15.6 21.1 26.7	17.827 16.725 15.780 14.835	14.066 12.656 11.450 10.254	3.760 4.068 4.330 4.582
			26.7/19.4	15.934	12.906	19.415	3.482	27.3					
			28.3/20.6	16.000	13.760	19.485	3.485	27.3					
			30.0/21.7	16.070	14.624	19.560	3.490	27.3					
	3.60 3.60 3.60 3.60	42.70	23.9/17.2	16.550	12.412	19.935	3.385	25.9		10.0 15.6 21.1 26.7	18.063 16.943 15.990 15.028	14.228 12.800 11.586 10.353	3.835 4.143 4.404 4.675
			26.7/19.4	16.685	13.515	20.077	3.392	25.9					
			28.3/20.6	16.762	14.415	20.158	3.396	25.9					
			30.0/21.7	16.844	15.328	20.244	3.400	25.9					
29.4	1.80 1.80 1.80 1.80	13.10	23.9/17.2	13.335	10.268	17.277	3.942	37.7	21.1	10.0 15.6 21.1 26.7	22.087 20.722 19.550 18.378	17.981 16.290 14.838 13.376	4.106 4.432 4.712 5.001
			26.7/19.4	13.441	11.209	17.391	3.951	37.7					
			28.3/20.6	13.501	11.935	17.457	3.956	37.7					
			30.0/21.7	13.565	13.022	17.526	3.961	37.8					
	2.71 2.71 2.71 2.71	26.20	23.9/17.2	14.507	11.170	18.264	3.757	35.2		10.0 15.6 21.1 26.7	23.093 21.667 20.434 19.209	18.884 17.123 15.600 14.086	4.208 4.544 4.834 5.123
			26.7/19.4	14.623	12.196	18.388	3.765	35.2					
			28.3/20.6	14.689	12.985	18.459	3.769	35.3					
			30.0/21.7	14.760	14.170	18.534	3.774	35.3					
	3.60 3.60 3.60 3.60	42.70	23.9/17.2	15.300	11.781	18.960	3.660	33.9		10.0 15.6 21.1 26.7	23.399 21.947 20.705 19.463	19.116 17.319 15.778 14.237	4.283 4.628 4.927 5.225
			26.7/19.4	15.435	12.873	19.103	3.668	34.0					
			28.3/20.6	15.512	13.713	19.184	3.672	34.0					
			30.0/21.7	15.594	14.971	19.271	3.677	34.0					
32.2	1.80 1.80 1.80 1.80	13.10	23.9/17.2	12.857	9.964	16.948	4.091	40.3	29.4	10.0 15.6 21.1 26.7	24.632 23.110 21.798 20.495	20.237 18.361 16.750 15.148	4.395 4.750 5.048 5.347
			26.7/19.4	12.966	10.917	17.066	4.100	40.4					
			28.3/20.6	13.029	11.634	17.133	4.105	40.4					
			30.0/21.7	13.095	12.702	17.205	4.110	40.4					
	2.71 2.71 2.71 2.71	26.20	23.9/17.2	13.999	10.850	17.942	3.942	37.9		10.0 15.6 21.1 26.7	25.752 24.160 22.795 21.422	21.254 19.298 17.617 15.935	4.498 4.862 5.179 5.487
			26.7/19.4	14.109	11.880	18.060	3.951	37.9					
			28.3/20.6	14.171	12.655	18.127	3.956	38.0					
			30.0/21.7	14.238	13.811	18.199	3.961	38.0					
	3.60 3.60 3.60 3.60	42.70	23.9/17.2	14.807	11.475	18.637	3.830	36.7		10.0 15.6 21.1 26.7	26.093 24.475 23.093 21.711	21.502 19.520 17.821 16.121	4.591 4.955 5.272 5.589
			26.7/19.4	14.916	12.560	18.755	3.839	36.7					
			28.3/20.6	14.979	13.376	18.823	3.844	36.7					
			30.0/21.7	15.045	14.594	18.894	3.849	36.7					
37.8	1.80 1.80 1.80 1.80	13.10	23.9/17.2	12.018	9.495	16.444	4.426	45.7	32.2	10.0 15.6 21.1 26.7	25.349 23.775 22.428 21.090	20.861 18.932 17.277 15.631	4.488 4.843 5.151 5.459
			26.7/19.4	12.128	10.430	16.563	4.435	45.7					
			28.3/20.6	12.190	11.093	16.631	4.441	45.7					
			30.0/21.7	12.257	12.134	16.703	4.447	45.8					
	2.71 2.71 2.71 2.71	26.20	23.9/17.2	13.085	10.337	17.324	4.239	43.3		10.0 15.6 21.1 26.7	25.752 24.160 22.795 21.422	21.254 19.298 17.617 15.935	4.498 4.862 5.179 5.487
			26.7/19.4	13.195	11.347	17.443	4.249	43.3					
			28.3/20.6	13.257	12.064	17.511	4.254	43.4					
			30.0/21.7	13.324	13.190	17.584	4.260	43.4					
	3.60 3.60 3.60 3.60	42.70	23.9/17.2	13.870	10.957	17.961	4.091	42.1		10.0 15.6 21.1 26.7	26.093 24.475 23.093 21.711	21.502 19.520 17.821 16.121	4.591 4.955 5.272 5.589
			26.7/19.4	13.984	12.026	18.084	4.100	42.1					
			28.3/20.6	14.049	12.785	18.154	4.105	42.1					
			30.0/21.7	14.119	13.978	18.229	4.110	42.2					
43.3	42.70	23.9/17.2	12.943	10.484	17.370	4.427	47.4	10.0 15.6 21.1 26.7	25.349 23.775 22.428 21.090	20.861 18.932 17.277 15.631	4.488 4.843 5.151 5.459		
		26.7/19.4	13.143	11.566	17.579	4.436	47.5						
		28.3/20.6	13.257	12.329	17.698	4.441	47.5						
		30.0/21.7	13.378	13.245	17.824	4.446	47.6						

All data is with 100% water (no antifreeze) and no pumping penalty. Unit kW data includes fan motor.

Total Capacity Correction Factory (% by Weight)

	10%	15%	20%
METHANOL	1.00	0.99	0.99
Cooling	1.00	0.99	0.99
Heating	0.99	0.98	0.97

	10%	15%	20%
ETHANOL	1.00	1.00	1.00
Cooling	1.00	1.00	1.00
Heating	0.99	0.98	0.97

	15%	20%	25%
PROPYLENE GLYCOL	0.98	0.97	0.96
Cooling	0.98	0.97	0.96
Heating	0.96	0.95	0.93

Capacity Data

Split System Unit Size 072

Low Temperature Operation – Anti-freeze Require

Ent. Water. °C	Water-Flow M ³ /h	Pressure Drop kpa	COOLING						HEATING				
			Ent. Air Db/wb°C	Total Watts	Sensible Watts	Ht. Rej Watts	Unit kW	Lvg. Water. °C	Ent. Water. °C	Ent. Air °C	Total Watts	Ht. Abs Watts	Unit kW
4.4	2.05 2.05 2.05 2.05	15.90	23.9/17.2	20.140	14.501	23.496	3.356	14.3	-4	10.0	13.671	9.625	4.046
			26.7/19.4	20.273	15.813	23.634	3.362	14.3		15.6	13.000	9.434	3.566
			28.3/20.6	20.349	16.889	23.713	3.365	14.3		21.1	12.411	9.208	3.203
			30.0/21.7	20.430	18.387	23.797	3.368	14.4		26.7	11.831	8.948	2.883
	3.10 3.10 3.10 3.10	31.00	23.9/17.2	21.950	15.804	25.167	3.217	11.4		10.0	13.858	9.828	4.030
			26.7/19.4	22.098	17.236	25.321	3.223	11.4		15.6	13.175	9.627	3.548
			28.3/20.6	22.182	18.411	25.408	3.226	11.4		21.1	12.583	9.397	3.186
			30.0/21.7	22.271	20.044	25.502	3.230	11.5		26.7	11.997	9.131	2.866
	4.20 4.20 4.20 4.20	51.70	23.9/17.2	22.247	16.018	25.373	3.126	9.6		10.0	14.047	10.033	4.014
			26.7/19.4	22.404	17.475	25.535	3.131	9.6		15.6	13.352	9.822	3.531
			28.3/20.6	22.494	18.670	25.628	3.134	9.6		21.1	12.759	9.590	3.169
			30.0/21.7	22.589	20.330	25.726	3.137	9.7		26.7	12.166	9.316	2.849
10.0	2.05 2.05 2.05 2.05	15.90	23.9/17.2	19.223	14.033	22.854	3.631	19.6	4.4	10.0	15.724	11.297	4.427
			26.7/19.4	19.356	15.291	22.994	3.638	19.6		15.6	14.747	10.908	3.839
			28.3/20.6	19.432	16.323	23.073	3.641	19.7		21.1	13.921	10.511	3.410
			30.0/21.7	19.513	17.757	23.158	3.645	19.7		26.7	13.086	10.066	3.020
	3.10 3.10 3.10 3.10	31.00	23.9/17.2	20.858	15.226	24.353	3.495	16.8		10.0	16.437	11.920	4.517
			26.7/19.4	21.001	16.590	24.500	3.500	16.8		15.6	15.423	11.507	3.917
			28.3/20.6	21.082	17.709	24.585	3.503	16.8		21.1	14.550	11.077	3.474
			30.0/21.7	21.169	19.263	24.675	3.506	16.8		26.7	13.677	10.597	3.081
	4.20 4.20 4.20 4.20	51.70	23.9/17.2	22.134	16.158	25.490	3.356	15.2		10.0	16.653	12.171	4.482
			26.7/19.4	22.281	17.602	25.643	3.362	15.2		15.6	15.630	11.737	3.893
			28.3/20.6	22.365	18.787	25.730	3.365	15.3		21.1	14.738	11.283	3.455
			30.0/21.7	22.455	20.434	25.823	3.368	15.3		26.7	13.856	10.795	3.061
21.1	2.05 2.05 2.05 2.05	15.90	23.9/17.2	17.435	13.076	21.908	4.473	30.3	10.0	10.0	18.305	13.479	4.826
			26.7/19.4	17.551	14.216	22.031	4.480	30.3		15.6	17.169	12.984	4.186
			28.3/20.6	17.617	15.151	22.102	4.485	30.4		21.1	16.193	12.481	3.712
			30.0/21.7	17.688	16.096	22.177	4.489	30.4		26.7	15.226	11.933	3.293
	3.10 3.10 3.10 3.10	31.00	23.9/17.2	19.067	14.300	23.361	4.294	27.6		10.0	19.131	14.213	4.919
			26.7/19.4	19.183	15.538	23.484	4.301	27.6		15.6	17.948	13.683	4.265
			28.3/20.6	19.249	16.554	23.554	4.305	27.6		21.1	16.935	13.153	3.781
			30.0/21.7	19.319	17.581	23.628	4.309	27.7		26.7	15.921	12.561	3.360
	4.20 4.20 4.20 4.20	51.70	23.9/17.2	19.953	14.965	24.137	4.184	26.0		10.0	19.385	14.498	4.887
			26.7/19.4	20.088	16.272	24.279	4.190	26.1		15.6	18.183	13.940	4.243
			28.3/20.6	20.165	17.342	24.360	4.194	26.1		21.1	17.160	13.393	3.767
			30.0/21.7	20.247	18.425	24.446	4.198	26.1		26.7	16.127	12.792	3.335
29.4	2.05 2.05 2.05 2.05	15.90	23.9/17.2	16.077	12.379	20.949	4.872	38.2	21.1	10.0	23.703	18.121	5.581
			26.7/19.4	16.182	13.496	21.063	4.881	38.2		15.6	22.238	17.388	4.851
			28.3/20.6	16.242	14.358	21.128	4.885	38.3		21.1	20.981	16.676	4.305
			30.0/21.7	16.306	15.654	21.197	4.891	38.3		26.7	19.723	15.910	3.812
	3.10 3.10 3.10 3.10	31.00	23.9/17.2	17.490	13.467	22.133	4.643	35.5		10.0	24.782	19.089	5.693
			26.7/19.4	17.606	14.683	22.257	4.651	35.6		15.6	23.252	18.305	4.947
			28.3/20.6	17.672	15.622	22.327	4.655	35.6		21.1	21.929	17.543	4.386
			30.0/21.7	17.743	17.033	22.402	4.660	35.6		26.7	20.614	16.724	3.890
	4.20 4.20 4.20 4.20	51.70	23.9/17.2	18.450	14.207	22.973	4.523	34.1		10.0	25.111	19.443	5.668
			26.7/19.4	18.585	15.500	23.116	4.531	34.1		15.6	23.553	18.633	4.920
			28.3/20.6	18.662	16.497	23.197	4.535	34.1		21.1	22.220	17.859	4.360
			30.0/21.7	18.744	17.994	23.284	4.540	34.2		26.7	20.887	17.022	3.864
32.2	2.05 2.05 2.05 2.05	15.90	23.9/17.2	15.502	12.014	20.559	5.056	40.8	29.4	10.0	26.435	20.620	5.815
			26.7/19.4	15.612	13.145	20.677	5.065	40.9		15.6	24.801	19.753	5.048
			28.3/20.6	15.674	13.997	20.744	5.070	40.9		21.1	23.393	18.913	4.480
			30.0/21.7	15.740	15.268	20.816	5.075	40.9		26.7	21.994	18.017	3.977
	3.10 3.10 3.10 3.10	31.00	23.9/17.2	16.877	13.080	21.749	4.872	38.2		10.0	27.636	21.696	5.941
			26.7/19.4	16.987	14.303	21.867	4.881	38.3		15.6	25.928	20.771	5.156
			28.3/20.6	17.049	15.225	21.934	4.885	38.3		21.1	24.463	19.896	4.567
			30.0/21.7	17.115	16.602	22.006	4.891	38.3		26.7	22.989	18.939	4.051
	4.20 4.20 4.20 4.20	51.70	23.9/17.2	17.849	13.833	22.583	4.734	36.8		10.0	28.002	22.105	5.897
			26.7/19.4	17.958	15.121	22.700	4.742	36.8		15.6	26.266	21.141	5.125
			28.3/20.6	18.021	16.092	22.768	4.747	36.9		21.1	24.782	20.238	4.545
			30.0/21.7	18.087	17.544	22.839	4.752	36.9		26.7	23.299	19.269	4.030
37.8	2.05 2.05 2.05 2.05	15.90	23.9/17.2	14.494	11.450	19.964	5.470	46.2	32.2	10.0	27.204	21.344	5.860
			26.7/19.4	14.603	12.559	20.083	5.479	46.2		15.6	25.515	20.421	5.094
			28.3/20.6	14.666	13.346	20.150	5.485	46.3		21.1	24.069	19.551	4.518
			30.0/21.7	14.732	14.585	20.223	5.490	46.3		26.7	22.633	18.624	4.009
	3.10 3.10 3.10 3.10	31.00	23.9/17.2	15.777	12.464	21.016	5.239	43.6		10.0	28.002	22.105	5.897
			26.7/19.4	15.887	13.662	21.135	5.249	43.7		15.6	26.266	21.141	5.125
			28.3/20.6	15.949	14.514	21.203	5.254	43.7		21.1	24.782	20.238	4.545
			30.0/21.7	16.015	15.855	21.275	5.260	43.7		26.7	23.299	19.269	4.030
	4.20 4.20 4.20 4.20	51.70	23.9/17.2	16.723	13.211	21.779	5.056	42.3		10.0	27.204	21.344	5.860
			26.7/19.4	16.837	14.480	21.902	5.065	42.3		15.6	25.515	20.421	5.094
			28.3/20.6	16.902	15.381	21.972	5.070	42.3		21.1	24.069	19.551	4.518
			30.0/21.7	16.972	16.802	22.047	5.075	42.3		26.7	22.633	18.624	4.009
43.3	51.70	23.9/17.2	15.635	12.665	21.106	5.471	47.6	10.0	27.204	21.344	5.860		
		26.7/19.4	15.835	13.935	21.315	5.480	47.7	15.6	25.515	20.421	5.094		
		28.3/20.6	15.949	14.833	21.434	5.485	47.7	21.1	24.069	19.551	4.518		
		30.0/21.7	16.070	15.910	21.560	5.490	47.7	26.7	22.633	18.624	4.009		

All data is with 100% water (no antifreeze) and no pumping penalty. Unit kW data includes fan motor.

Total Capacity Correction Factory (% by Weight)

	10%	15%	20%
METHANOL			
Cooling	1.00	0.99	0.99
Heating	0.99	0.98	0.97

	10%	15%	20%
ETHANOL			
Cooling	1.00	1.00	1.00
Heating	0.99	0.98	0.97

	15%	20%	25%
PROPYLENE GLYCOL			
Cooling	0.98	0.97	0.96
Heating	0.96	0.95	0.93

Capacity Data

Split System Unit Size 086

Low Temperature Operation - Anti-freeze Require

Ent. Water. °C	Water-Flow M ³ /h	Pressure Drop kpa	COOLING						HEATING				
			Ent. Air Db/wb°C	Total Watts	Sensible Watts	Ht. Rej Watts	Unit kW	Lvg. Water. °C	Ent. Water. °C	Ent. Air °C	Total Watts	Ht. Abs Watts	Unit kW
4.4	2.50 2.50 2.50 2.50	22.10	23.9/17.2	23.917	17.220	27.714	3.797	13.9	-4	10.0	14.558	11.076	3.482
			26.7/19.4	24.050	18.759	27.853	3.803	14.0		15.6	13.838	10.080	3.758
			28.3/20.6	24.126	20.024	27.932	3.806	14.0		21.1	13.205	9.212	3.994
			30.0/21.7	24.207	21.786	28.015	3.809	14.0		26.7	12.583	8.353	4.230
	3.75 3.75 3.75 3.75	33.60	23.9/17.2	26.068	18.769	29.708	3.640	11.2		10.0	14.757	11.213	3.544
			26.7/19.4	26.215	20.448	29.861	3.646	11.2		15.6	14.024	10.197	3.827
			28.3/20.6	26.299	21.828	29.949	3.649	11.3		21.1	13.389	9.318	4.071
			30.0/21.7	26.389	23.750	30.042	3.653	11.3		26.7	12.759	8.445	4.314
	5.00 5.00 5.00 5.00	52.00	23.9/17.2	26.422	19.024	29.959	3.537	9.6		10.0	14.958	11.351	3.607
			26.7/19.4	26.579	20.732	30.121	3.542	9.6		15.6	14.212	10.315	3.898
			28.3/20.6	26.669	22.135	30.214	3.545	9.6		21.1	13.575	9.426	4.149
			30.0/21.7	26.764	24.088	30.312	3.548	9.6		26.7	12.938	8.537	4.401
10.0	2.50 2.50 2.50 2.50	22.10	23.9/17.2	22.830	16.666	26.939	4.109	19.3	4.4	10.0	16.796	13.135	3.661
			26.7/19.4	22.963	18.141	27.078	4.115	19.3		15.6	15.753	11.794	3.959
			28.3/20.6	23.039	19.353	27.158	4.119	19.3		21.1	14.871	10.663	4.208
			30.0/21.7	23.120	21.039	27.242	4.122	19.4		26.7	13.978	9.512	4.466
	3.75 3.75 3.75 3.75	33.60	23.9/17.2	24.771	18.083	28.725	3.954	16.6		10.0	17.558	13.808	3.750
			26.7/19.4	24.914	19.682	28.873	3.959	16.6		15.6	16.475	12.416	4.059
			28.3/20.6	24.995	20.996	28.957	3.962	16.6		21.1	15.542	11.225	4.317
			30.0/21.7	25.082	22.824	29.047	3.965	16.7		26.7	14.610	10.034	4.576
	5.00 5.00 5.00 5.00	52.00	23.9/17.2	26.285	19.188	30.083	3.797	15.2		10.0	17.788	13.959	3.830
			26.7/19.4	26.433	20.882	30.235	3.803	15.2		15.6	16.695	12.557	4.138
			28.3/20.6	26.517	22.274	30.322	3.806	15.2		21.1	15.743	11.346	4.397
			30.0/21.7	26.606	24.212	30.415	3.809	15.2		26.7	14.800	10.135	4.665
21.1	2.50 2.50 2.50 2.50	22.10	23.9/17.2	20.705	15.529	25.766	5.061	30.0	10.0	10.0	19.553	15.644	3.909
			26.7/19.4	20.821	16.865	25.889	5.068	30.0		15.6	18.340	14.112	4.228
			28.3/20.6	20.887	17.963	25.960	5.073	30.0		21.1	17.297	12.801	4.496
			30.0/21.7	20.958	19.072	26.035	5.077	30.1		26.7	16.264	11.499	4.765
	3.75 3.75 3.75 3.75	33.60	23.9/17.2	22.640	16.980	27.498	4.859	27.4		10.0	20.436	16.427	4.009
			26.7/19.4	22.756	18.432	27.621	4.865	27.4		15.6	19.172	14.835	4.337
			28.3/20.6	22.822	19.627	27.691	4.869	27.4		21.1	18.089	13.474	4.616
			30.0/21.7	22.892	20.832	27.765	4.873	27.5		26.7	17.006	12.122	4.884
	5.00 5.00 5.00 5.00	52.00	23.9/17.2	23.697	17.772	28.430	4.734	26.0		10.0	20.706	16.618	4.088
			26.7/19.4	23.831	19.303	28.572	4.740	26.0		15.6	19.423	15.006	4.417
			28.3/20.6	23.909	20.561	28.653	4.744	26.0		21.1	18.330	13.635	4.695
			30.0/21.7	23.990	21.831	28.738	4.748	26.0		26.7	17.227	12.243	4.984
29.4	2.50 2.50 2.50 2.50	22.10	23.9/17.2	19.091	14.700	24.604	5.513	37.9	21.1	10.0	25.319	20.942	4.377
			26.7/19.4	19.197	16.010	24.718	5.521	37.9		15.6	23.755	19.030	4.725
			28.3/20.6	19.257	17.023	24.783	5.526	37.9		21.1	22.411	17.388	5.024
			30.0/21.7	19.321	18.548	24.853	5.531	37.9		26.7	21.067	15.736	5.332
	3.75 3.75 3.75 3.75	33.60	23.9/17.2	20.770	15.993	26.024	5.253	35.4		10.0	26.472	21.986	4.486
			26.7/19.4	20.886	17.419	26.147	5.261	35.4		15.6	24.838	19.993	4.844
			28.3/20.6	20.953	18.522	26.218	5.265	35.4		21.1	23.424	18.271	5.153
			30.0/21.7	21.023	20.182	26.293	5.270	35.4		26.7	22.020	16.559	5.461
	5.00 5.00 5.00 5.00	52.00	23.9/17.2	21.914	16.874	27.032	5.118	34.0		10.0	26.823	22.257	4.566
			26.7/19.4	22.049	18.389	27.175	5.126	34.1		15.6	25.159	20.225	4.934
			28.3/20.6	22.126	19.560	27.256	5.130	34.1		21.1	23.735	18.482	5.252
			30.0/21.7	22.208	21.320	27.343	5.134	34.1		26.7	22.311	16.740	5.571
32.2	2.50 2.50 2.50 2.50	22.10	23.9/17.2	18.412	14.269	24.133	5.721	40.5	29.4	10.0	28.237	23.552	4.685
			26.7/19.4	18.521	15.595	24.251	5.730	40.5		15.6	26.492	21.429	5.063
			28.3/20.6	18.583	16.595	24.318	5.735	40.6		21.1	24.988	19.606	5.382
			30.0/21.7	18.650	18.090	24.390	5.740	40.6		26.7	23.494	17.794	5.700
	3.75 3.75 3.75 3.75	33.60	23.9/17.2	20.042	15.532	25.554	5.513	38.1		10.0	29.520	24.726	4.795
			26.7/19.4	20.151	16.967	25.672	5.521	38.1		15.6	27.695	22.513	5.183
			28.3/20.6	20.214	18.051	25.740	5.526	38.1		21.1	26.131	20.610	5.521
			30.0/21.7	20.280	19.671	25.811	5.531	38.1		26.7	24.557	18.708	5.849
	5.00 5.00 5.00 5.00	52.00	23.9/17.2	21.194	16.425	26.550	5.356	36.8		10.0	29.911	25.017	4.894
			26.7/19.4	21.303	17.937	26.668	5.365	36.8		15.6	28.056	22.774	5.282
			28.3/20.6	21.366	19.079	26.735	5.370	36.8		21.1	26.472	20.852	5.620
			30.0/21.7	21.432	20.789	26.807	5.375	36.8		26.7	24.888	18.929	5.959
37.8	2.50 2.50 2.50 2.50	22.10	23.9/17.2	17.216	13.601	23.405	6.189	45.8	32.2	10.0	29.059	24.274	4.785
			26.7/19.4	17.326	14.900	23.524	6.198	45.9		15.6	27.254	22.091	5.163
			28.3/20.6	17.388	15.823	23.592	6.204	45.9		21.1	25.710	20.219	5.491
			30.0/21.7	17.454	17.280	23.664	6.210	45.9		26.7	24.176	18.357	5.819
	3.75 3.75 3.75 3.75	33.60	23.9/17.2	18.738	14.803	24.666	5.928	43.5		10.0	30.520	26.122	4.934
			26.7/19.4	18.847	16.208	24.785	5.938	43.5		15.6	28.695	23.913	5.322
			28.3/20.6	18.909	17.208	24.853	5.943	43.5		21.1	27.131	21.794	5.650
			30.0/21.7	18.976	18.786	24.925	5.949	43.5		26.7	25.557	19.878	5.978
	5.00 5.00 5.00 5.00	52.00	23.9/17.2	19.860	15.690	25.582	5.721	42.2		10.0	31.911	27.017	5.082
			26.7/19.4	19.975	17.178	25.704	5.730	42.2		15.6	29.956	24.874	5.470
			28.3/20.6	20.040	18.236	25.774	5.735	42.2		21.1	28.056	22.774	5.858
			30.0/21.7	20.109	19.908	25.849	5.740	42.2		26.7	26.472	20.852	6.186
43.3	5.00 5.00 5.00 5.00	52.00	23.9/17.2	18.596	15.063	24.786	6.190	47.6	32.2	10.0	30.520	26.122	4.934
			26.7/19.4	18.795	16.540	24.994	6.199	47.6		15.6	28.695	23.913	5.322
			28.3/20.6	18.909	17.586	25.113	6.204	47.6		21.1	27.131	21.794	5.650
			30.0/21.7	19.031	18.840	25.240	6.209	47.6		26.7	25.557	19.878	5.978

All data is with 100% water (no antifreeze) and no pumping penalty. Unit kW data includes fan motor.

Total Capacity Correction Factory (% by Weight)

METHANOL	10%	15%	20%
Cooling	1.00	0.99	0.99
Heating	0.99	0.98	0.97

ETHANOL	10%	15%	20%
Cooling	1.00	1.00	1.00
Heating	0.99	0.98	0.97

PROPYLENE GLYCOL	15%	20%	25%
Cooling	0.98	0.97	0.96
Heating	0.96	0.95	0.93

Fan Performance

Unit Size	External Static Pressure (Pa)															
	0			30			50			80			100			Min m ³ /h
006	520	378	235	480	353	300	520	397	177	-	-	-	-	-	-	
009	520	378	235	510	353	300	520	397	177	-	-	-	-	-	-	170
013	670	570	461	580	493	370	580	480	360	-	-	-	-	-	-	260
016	708	520	360	700	521	348	700	583	422	-	-	-	-	-	-	320
019	788	545	363	795	620	368	790	600	390	-	-	-	-	-	-	363
024	1125	788	550	950	691	397	950	643	425	-	-	-	-	-	-	397
027	1460	1035	680	1250	778	433	1415	1150	950	-	-	-	-	-	-	680
030	1704	1270	903	1430	982	553	1580	1260	990	-	-	-	-	-	-	553
036	2090	1555	1038	2088	1500	875	1750	1542	1243	-	-	-	-	-	-	875
043	2285	1660	1070	2190	1658	955	2000	1710	1450	-	-	-	-	-	-	1070
052	2820	1990	1270	2844	1620	1290	2200	1842	1190	-	-	-	-	-	-	1290
062	2820	1990	1270	2844	1620	1290	2500	1842	1190	2500	1650	1295	-	-	-	1190
072	-	-	-	-	-	-	3400	2900	2450	3200	2640	2153	3200	2450	2015	2015
086	-	-	-	-	-	-	4200	3200	2500	4000	2990	2005	4000	3485	2940	2940

Air Flow Correction Factor

	Percent							
	80	85	90	95	100	105	110	115
Total Cooling	.980	.986	.989	.994	1.000	1.011	1.017	1.023
Sensible Cooling	.902	.931	.960	.978	1.000	1.025	1.051	1.078
Total Heat of Rejection	.981	.985	.989	.996	1.000	1.009	1.015	1.021
Cooling kW	.980	.985	.990	.995	1.000	1.005	1.010	1.015
Total Heating	.970	.979	.989	.994	1.000	1.009	1.017	1.025
Total Heat of Absorption	.951	.968	.983	.991	1.000	1.017	1.031	1.045
Heating kW	1.030	1.020	1.010	1.005	1.000	.995	.988	.981

Electrical Data

Model	Voltage	Compressor		Fan Motor FLA	Total Amps	Min. / Max. Volts	Min. / Circuit Ampacity	Max. Breaker Size	Max. Fuse Size
		RLA	LRA						
006	220~240/50/1	2.4	23	0.1	2.5	198/242	3.0	4.5	10
	208~230/60/1	2.9	28	0.1	3.0	188/253	3.6	5.4	10
009	220~240/50/1	4.4	23	0.1	4.5	198/242	5.4	8.1	10
	208~230/60/1	5.3	28	0.1	5.4	188/253	6.5	9.7	10
013	220~240/50/1	5.4	23	0.2	5.6	198/242	6.7	10.1	15
	208~230/60/1	6.5	28	0.2	6.7	188/253	8.1	12.1	15
016	220~240/50/1	6.9	32	0.2	7.1	198/242	8.5	12.8	15
	208~230/60/1	8.3	38	0.2	8.5	188/253	10.2	15.3	20
019	220~240/50/1	8.0	39	0.2	8.2	198/242	9.8	14.8	20
	208~230/60/1	9.6	47	0.2	9.8	188/253	11.8	17.7	20
024	220~240/50/1	8.8	42	0.2	9.0	198/242	10.8	16.2	20
	208~230/60/1	10.6	50	0.2	10.8	188/253	13.0	19.4	25

Electrical Data

Model	Voltage	Compressor		Fan Motor FLA	Total Amps	Min. / Max. Volts	Min. / Circuit Ampacity	Max. Breaker Size	Max. Fuse Size
		RLA	LRA						
027	220~240/50/1	11.6	67	0.6	12.2	198/242	14.6	22.0	25
	208~230/60/1	13.9	80	0.7	14.6	188/253	17.6	26.4	30
030	220~240/50/1	12.3	69	0.6	12.9	198/242	15.5	23.2	30
	208~230/60/1	14.8	83	0.7	15.5	188/253	18.6	27.9	30
036	380~415/50/3	12.3	69	0.7	13.0	342/456	15.6	23.4	30
	380/60/3	14.1	79	0.8	15.0	342/418	17.9	26.9	30
	460/60/3	12.3	69	0.7	13.0	414/506	15.6	23.4	30
043	380~415/50/3	6.9	45	0.8	7.7	342/456	9.2	13.9	15
	380/60/3	7.9	52	0.9	8.9	342/418	10.6	15.9	20
	460/60/3	6.9	45	0.8	7.7	414/506	9.2	13.9	15
052	380~415/50/3	8.2	56	1.1	9.3	342/456	11.2	16.7	20
	380/60/3	9.4	64	1.3	10.7	342/418	12.8	19.3	25
	460/60/3	8.2	56	1.1	9.3	414/506	11.2	16.7	20
062	380~415/50/3	8.2	56	1.1	9.3	342/456	11.2	16.7	20
	380/60/3	9.4	64	1.3	10.7	342/418	12.8	19.3	25
	460/60/3	8.2	56	1.1	9.3	414/506	11.2	16.7	20
072	380~415/50/3	9.7	69	3.0	12.7	342/456	15.2	22.9	25
	380/60/3	11.2	79	3.5	14.6	342/418	17.5	26.3	30
	460/60/3	9.7	69	3.0	12.7	414/506	15.2	22.9	26
086	380~415/50/3	13.5	87	3.8	17.3	342/456	20.8	31.1	35
	380/60/3	15.5	100	4.4	19.9	342/418	23.9	35.8	40
	460/60/3	13.5	87	3.8	17.3	414/506	20.8	31.1	35

RLA = Rated Load Amperage; LRA = Locked Rotor Amperage.

Application Limits

Water Temperatures°C	Standard Units		Extended Range Units	
	Cooling	Heating	Cooling	Heating
Minimum entering water temperature	20	10	4	-5
Normal entering water temperature	30	20	30	20
Maximum entering water temperature	43	32	43	32

Air Temperature°C	Standard Units		Extended Range Units	
	Cooling	Heating	Cooling	Heating
Minimum ambient air temperature	10	10	4	4
Normal ambient air temperature	27/19	20	27	21
Maximum ambient air temperature	38	20	38	20
Maximum entering air temperature	10	10	10	4
Normal entering air temperature	27/19	20	27/19	20
Maximum ambient air temperature	38	30	38/28	30

Dimensional Data

Condensing Unit

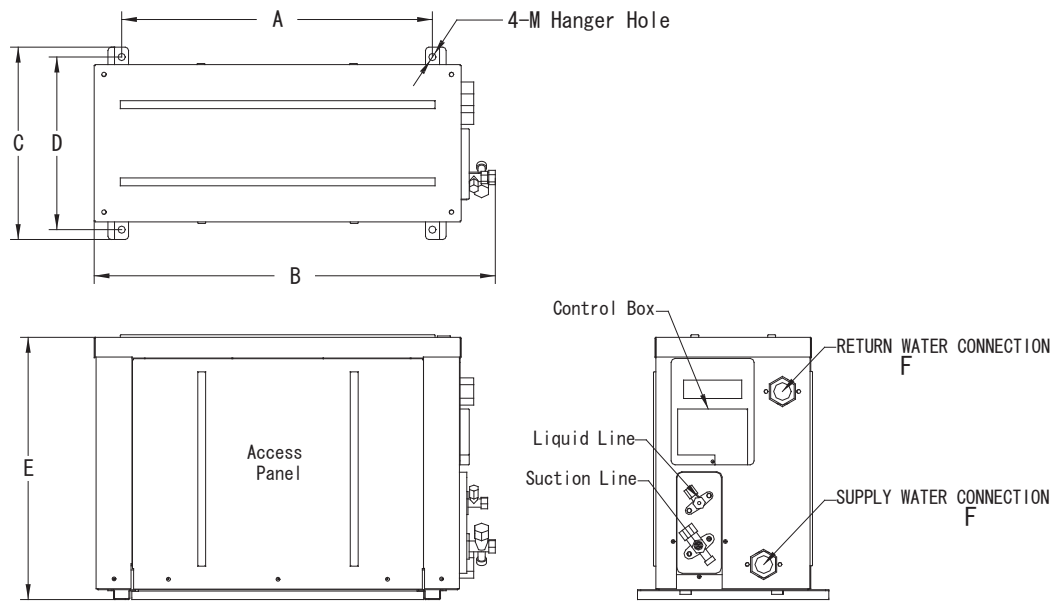

Unit Size	A	B	C	D	E	F	M	Liquid Line	Suction Line	Operation Weight (kg)	Shipping Weight (kg)
006	478	600	293	263	399	3/4" FEMALE NPT	Φ 11	Φ 6.35	Φ 9.52	33	38
009	478	600	293	263	399	3/4" FEMALE NPT	Φ 11	Φ 6.35	Φ 9.52	34	39
013	478	600	293	263	399	3/4" FEMALE NPT	Φ 11	Φ 6.35	Φ 9.52	35	45
016	478	600	293	263	399	3/4" FEMALE NPT	Φ 11	Φ 6.35	Φ 12.7	35	45
019	478	600	313	283	459	3/4" FEMALE NPT	Φ 11	Φ 6.35	Φ 12.7	37	47
024	478	600	313	283	459	3/4" FEMALE NPT	Φ 11	Φ 6.35	Φ 12.7	46	56
027	519	650	310	283	500	3/4" FEMALE NPT	Φ 11	Φ 6.35	Φ 12.7	47	57
030	519	650	310	283	500	3/4" FEMALE NPT	Φ 11	Φ 9.52	Φ 15.88	65	75
036	519	650	310	283	500	3/4" FEMALE NPT	Φ 11	Φ 9.52	Φ 19.05	65	75
043	659	800	410	380	540	3/4" FEMALE NPT	Φ 13	Φ 9.52	Φ 19.05	80	90
052	659	800	410	380	540	1" FEMALE NPT	Φ 13	Φ 9.52	Φ 19.05	80	90
062	659	800	410	380	540	1" FEMALE NPT	Φ 13	Φ 9.52	Φ 19.05	80	90
072	709	850	463	429	600	1" FEMALE NPT	Φ 13	Φ 15.88	Φ 22.23	95	105
086	709	850	463	429	600	1" FEMALE NPT	Φ 13	Φ 15.88	Φ 22.23	103	113

Dimensional Data

Indoor Unit

All dimensions are millimeters

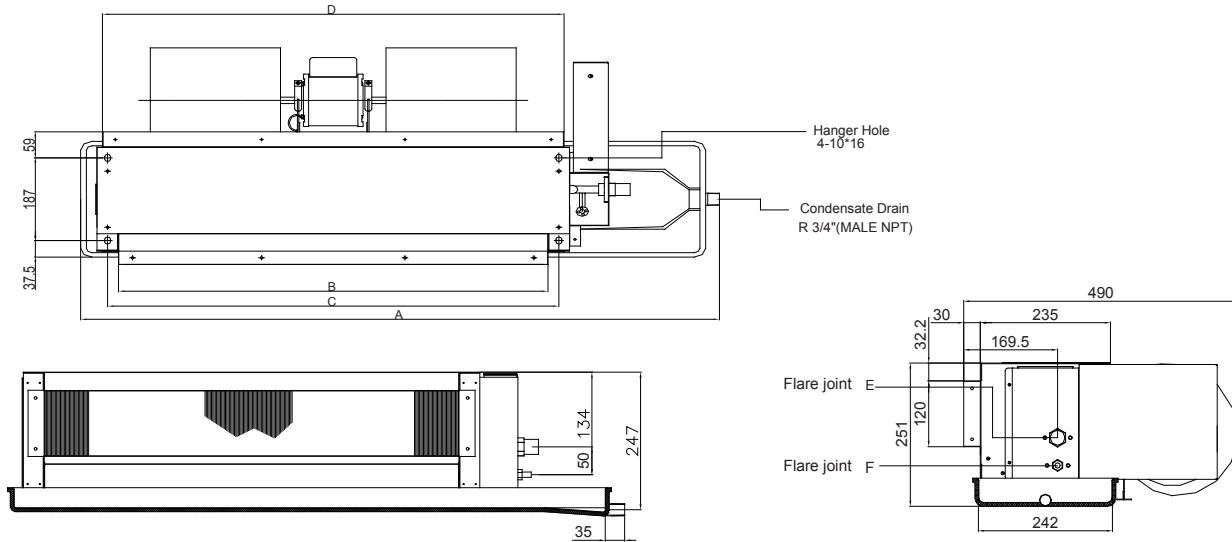

Unit Size	A	B	C	D	E	F	Number of Fans
006	814	448	497	505	Φ 6.35	Φ 9.52	1
009	814	448	497	505	Φ 6.35	Φ 9.52	1
013	814	448	497	505	Φ 6.35	Φ 9.52	1
016	984	618	667	675	Φ 6.35	Φ 12.7	1
019	1114	748	797	805	Φ 6.35	Φ 12.7	2
024	1114	748	797	805	Φ 6.35	Φ 12.7	2
027	1114	748	797	805	Φ 6.35	Φ 12.7	2
030	1314	948	997	1005	Φ 9.52	Φ15.88	2
036	1664	1298	1347	1355	Φ 9.52	Φ19.05	3
043	1664	1298	1347	1355	Φ 9.52	Φ19.05	3
052	1924	1588	1607	1445	Φ 9.52	Φ19.05	3
062	1924	1588	1607	1445	Φ 9.52	Φ19.05	3

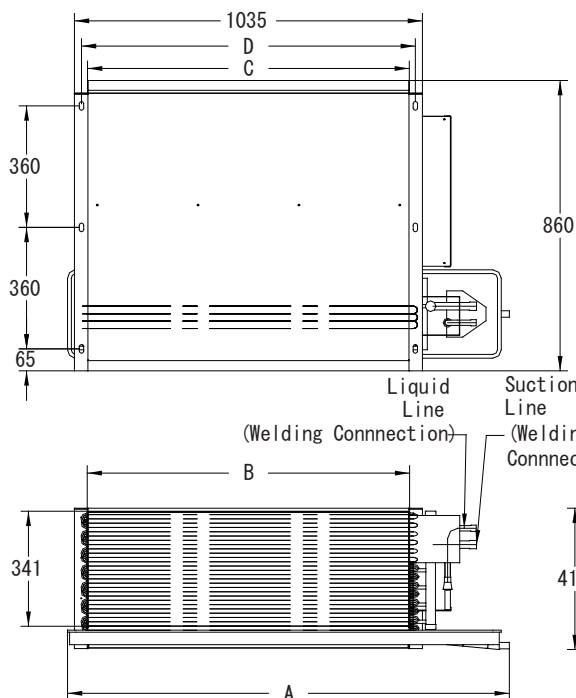

Unit Size	A	B	C	Liquid Line Size	Suction Line Size	Number of Fans
072	1314	959	957	Φ 15.88	Φ 22.23	2
086	1564	1209	1207	Φ 15.88	Φ 22.23	2

